

# D— PSC产品

## 百斯图工具制造有限公司

华东区域	East China Area	+0086 189 0219 0578
华北区域	North China Area	+0086 180 2001 0358
华中区域	Central China Area	+0086 189 0210 1516
东北区域	Northeast Area	+0086 133 3205 6691
西南区域	Southwest Area	+0086 189 0210 1516
西北区域	Northwest Area	+0086 133 5207 3018
广东区域	Guangdong Area	+0086 153 3200 8595
山东区域	Shandong Area	+0086 189 2021 6828
外贸销售	Export Sales	+0086 189 2008 0858

☎022-60379917   📍天津市武清区京滨工业园京滨大道99号  
✉softool.sale@cxtc.com   🌐www.xtc-softool.com



公众号二维码   视频号二维码

# D— PSC PRODUCT



百斯图工具制造有限公司  
SOFTOOL MANUFACTURING CO.,LTD.

2023 - V2

D—PSC产品

D - PSC Product

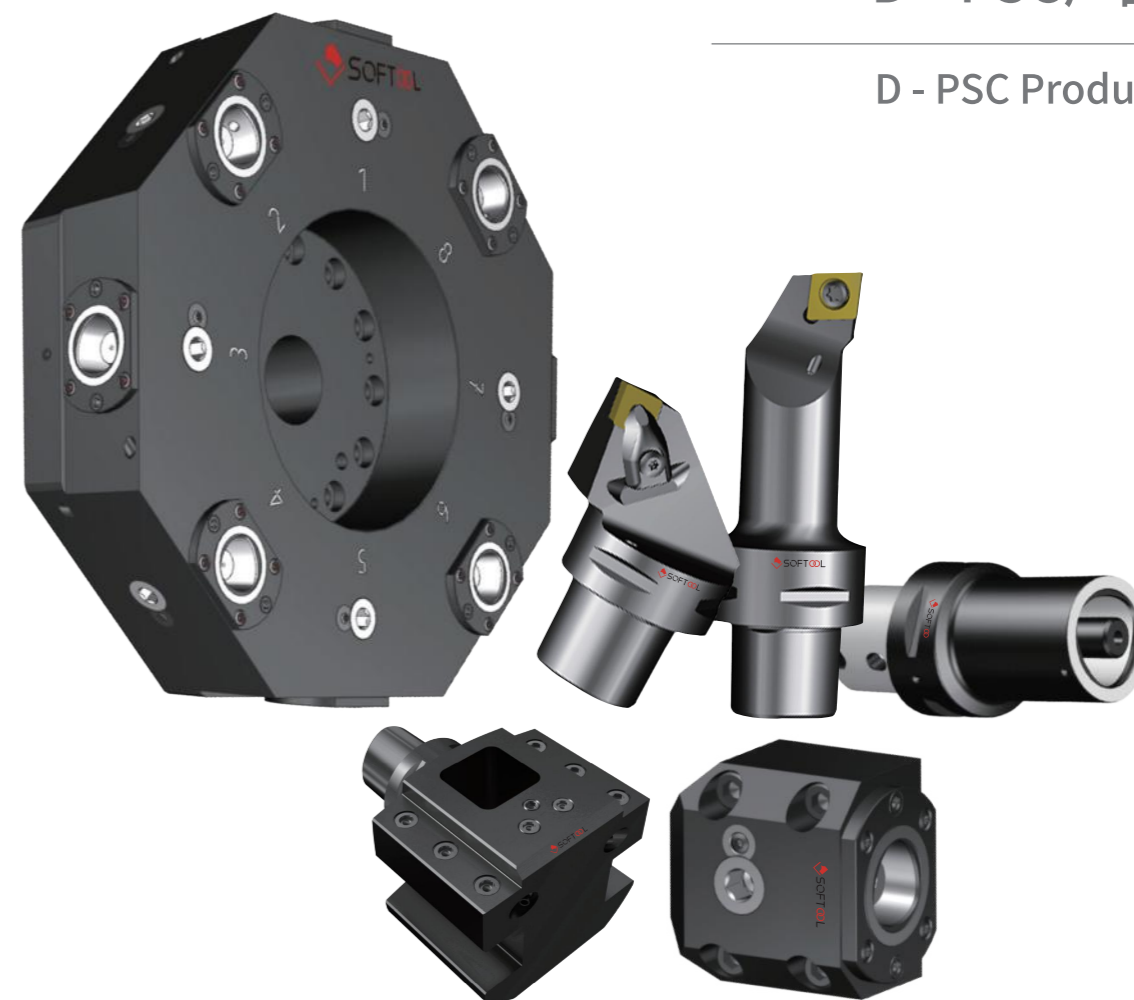

## 公司简介 COMPANY PROFILE

百斯图工具制造有限公司位于天津京滨工业园区，隶属于厦门钨业股份有限公司，新厂进行现代规模化投资并于2020年底投入使用，新厂配有多条自动化标准品产线，配备全套进口热处理、表面处理设备线，年产能达60万件。是一家专注于金属切削刀体的高新技术企业。

As a member of Xiamen Tungsten Co., Ltd., SofTool Manufacturing Co., Ltd. is located at Jingbin industrial park in Tianjin. With modern scale investment, the new plant has been put into use at the end of 2020. With multiple automated production lines, a full set of advanced heat treatment, surface processing equipment lines, the annual production capacity is expected to reach 600 thousand pieces, we are a high-tech enterprise focusing on metal cutting tool bodies.

集产品研发、工艺设计、生产制造、OEM/ODM代工、产品销售为一体的钢制品制造企业，为全球客户专业提供PSC产品、铣刀体、钻杆、镗刀、液压刀柄、热装刀柄、曲轴、型线刀具等产品及个性化专属解决方案，产品应用覆盖了风（核）能发电、模具制造、汽车、工程机械、铁路、石油化工等各个领域。

As a steel product manufacturing enterprise integrating product research and development, process design, manufacturing, OEM/ODM, and product sales, we provide professional cutter tools and personalized and exclusive solutions for PSC product, milling tool bodies, drilling stem, boring tools, shrink-fit chuck, hydraulic chuck, crank shaft for global customers. Our products are applied in wind (nuclear) power generation, mold manufacturing, automobiles, construction machinery, railways, petrochemicals and other fields.





# V 愿景 ision

构建全球刀具行业的协助平台，  
成为世界具有影响力的刀具企业。

To build a global synergistic platform  
for the cutting tools,  
to be one of the influential tool body  
manufacturing companies.

# M 使命 ission

引领刀体行业的健康发展；  
助力刀具企业的产业升级。

Leading the healthy development for  
the tool body industry;  
expediting the industrial upgrades  
for the tooling companies.

# C 核心价值观 ore Value

以品质铸就企业，  
以利益回馈客户，  
以价值成就员工。

To build the company with quality,  
to reward customers with benefits,  
to cultivate employees with value.

# S 品牌标语 logan

是刀具更是艺术。

Tooling also arts.

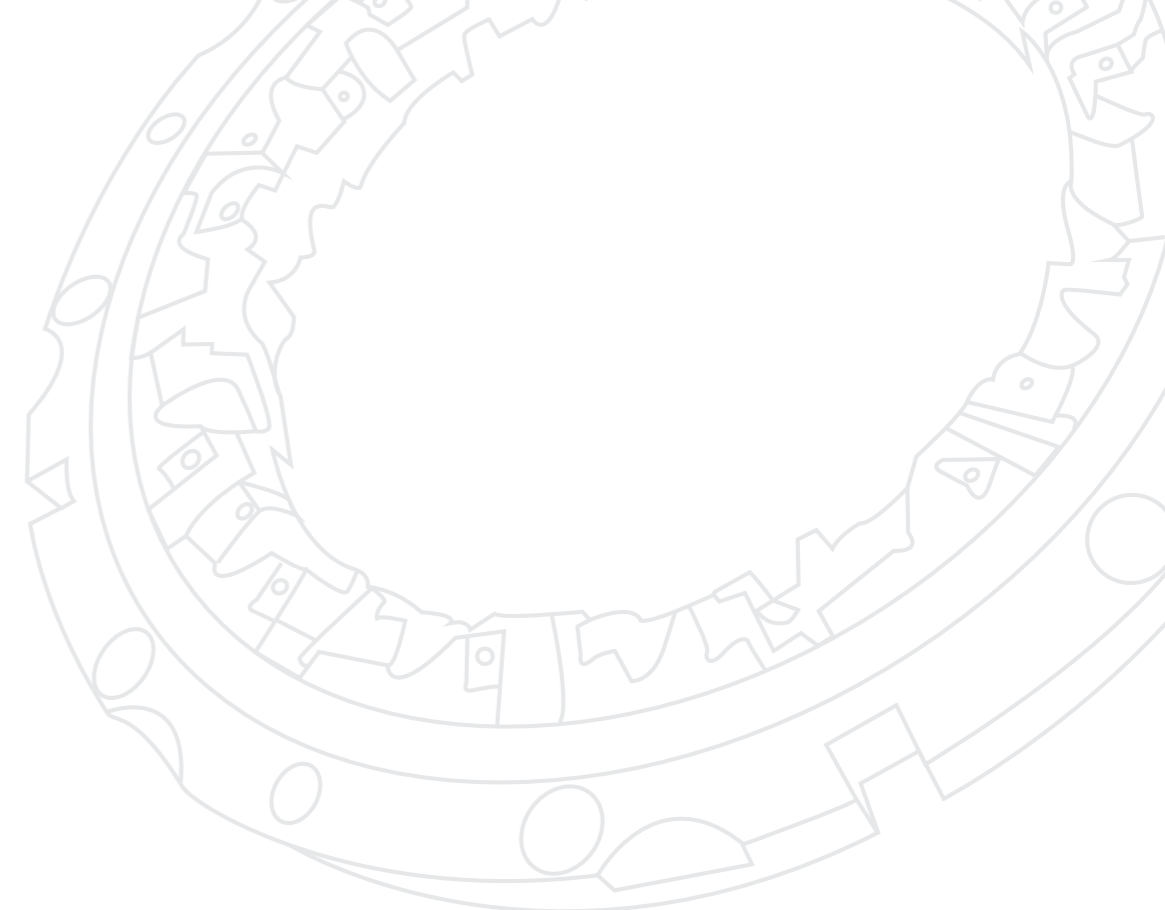
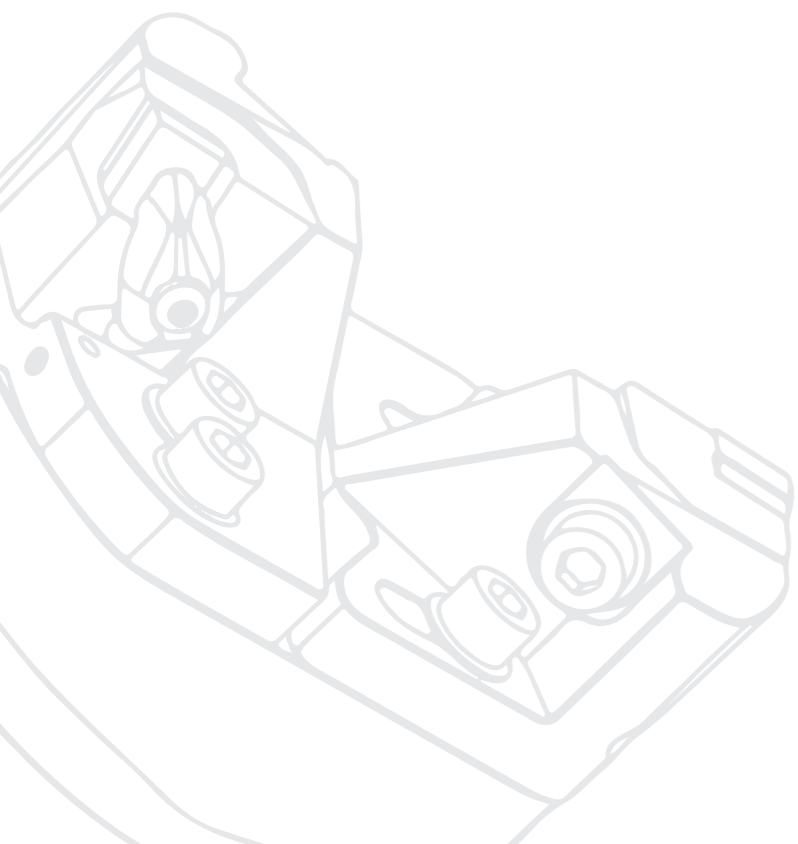





**SUPERIOR SERVICE**  
SUPERIOR SERVICE

## 优质服务

### SUPERIOR SERVICE

恪守“品质优先 客户至上”的服务宗旨，利用技术、产能和规模优势，为客户提供质量稳定的产品和交付快捷的服务。

Adhering to the service tenet of quality-oriented, customer first, we take advantage of technology, capacity and scale to provide customers with stable quality products and fast delivery services.

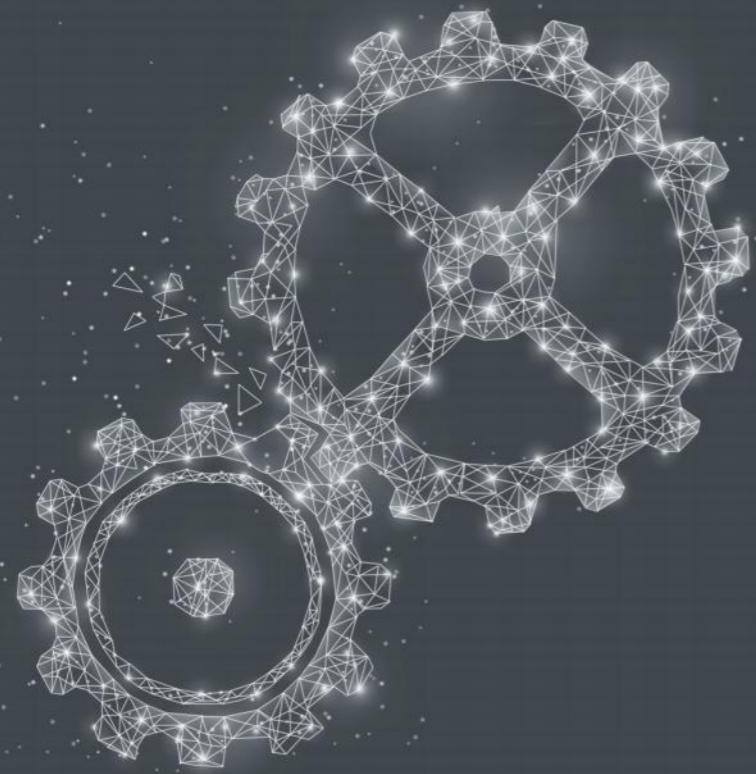

## 精湛技术

## ADVANCED TECHNOLOGY

经验丰富的技术人才、先进设计仿真平台、先进工艺控制流程、国际进口数控设备、系统信息化管理,为客户攻坚克难,提供刀体解决方案。

In order to provide cutting tools solution and overcome difficulties for customers, experienced technical talents, high-tech design simulation platform, advanced controlling process, CNC equipment, as well as system information management are integrated.

ADVANCED TECHNOLOGY  
ADVANCED TECHNOLOGY



LARGE SCALE  
LARGE SCALE

更大规模

LARGE SCALE

自动化生产线、国际进口热处理、表面处理加工设备线、投资10亿、年产能60万件，满足客户对产品的多种工艺需求。

Providing customers with various processing skills, such as automated production line, advanced heat treatment, surface processing equipment line with 1 billion investment and 600 thousand capacity to meet multiple demands.



非常感谢各位查阅百斯图2023年样册。

本样册共包含5本产品样本, 详见综合目录。

关于本产品样册中刊载的产品内容, 由于进行研究开发改良, 实际产品规格可能与产品样册中的规格有所不同, 以产品实际情况为准, 请予以理解。

\* 本样册所刊载所有产品均支持OEM贴牌业务。

可单独订购配件, 按需询价。

关于所刊载的产品, 带有如下标识:

● 可供现货      ▲ 交货时间短      ○ 按需求定制

Thank you very much for using the brochure from SofTool in 2023.

The brochure contains 5 product sample books in total. Please refer to the comprehensive catalog for details.

Due to the research, development and improvement, the actual product specifications may be a little different from the content in the product catalogue. The actual product will be taken as final. We highly appreciate your kind understanding.

\* It supports OEM business for all products in this brochure.

The spare parts can be ordered separately. Please inquire on demand.

The published products are labeled with following logos:

● available in stock      ▲ short lead time      ○ on request

## 综合目录

### COMPREHENSIVE CATALOG

A	液压刀柄	Hydraulic Chuck	
B	热装刀柄	Shrink-fit Chuck	
C	镗刀	Boring Tools	
◎	<b>D</b>	<b>PSC产品</b>	<b>PSC Product</b> 01-61
E	通用刀柄	General Tool Holder	

# D PSC产品 - 目录

## PSC PRODUCT CONTENTS

● 设计特点	Design Features	<b>D04</b>	SDUCR/L-Kr 93°		D35
			PSC毛坯	PSC Blank	D36
● 命名方式	Naming And Coding Rules	<b>D06</b>	● PSC接纳器	PSC Clamping Unit	<b>D38</b>
● 外圆车刀体	External Turning Tool Body	<b>D07</b>	命名方式	Naming And Coding Rules	D39
DCLNR/L-Kr 95°		D08	CUSA型	CUSA	D40
DDJNR/L-Kr 93° DDHNR/L-Kr 107.5° DDNNN-Kr 62.5°		D10	夹紧装置R\L RUSA应用设计说明	Clamping device R \ L Rusa application design description	D41
DSKNR/L-Kr 75° DSDNN-Kr 45° DSSNR/L-Kr 45°		D12	VDI外圆车刀接纳器	VDI External Receiver	D42
DWLNLR/L-Kr 95°		D14	VDI内圆车刀接纳器	VDI Internal Receiver	D43
DVJNR/L-Kr 93° DVWNN/L-Kr 72.5°		D16	卧式刀塔接纳器	Horizontal Lathe Receiver	D44
DTJNR/L-Kr 93°		D17	● 方柄接杆	Tool Holder Adaptor	<b>D45</b>
PCLNR/L-Kr 95°		D18	命名方式	Naming And Coding Rules	D46
PDJNR/L-Kr 93°		D20	通用刀柄0°接杆	General Purpose 0° Adaptor	D47
PSKNR/L-Kr 75°		D21	通用刀柄90°接杆	General Purpose 90° Adaptor	D48
SCLCR/L-Kr 95°		D22	通用刀柄0°双向接杆	General Purpose 0°Both-sides Adaptor	D49
SDJCR/L-Kr 93°		D23	● 转接柄	Adaptor	<b>D50</b>
SVHBR/L-Kr 107.5° SVJBR/L-Kr 93°		D24	命名方式	Naming And Coding Rules	D51
SRDCN SRSCR/L		D25	PSC加长杆	PSC Extension Adaptor	D52
● 内圆车刀体	Internal Turning Tool Body	<b>D26</b>	PSC缩颈杆	PSC Reduction Adaptor	D54
DCLNR/L-Kr 95°		D27	PSC转芯轴接柄	PSC with Type Arbor Adaptor	D56
DDUNR/L-Kr 93°		D28	BT转PSC接柄	BT with Type PSC Adaptor	D58
DWLNLR/L-Kr 95°		D29	HSK转PSC接柄	HSK with Type PSC Adapter	D60
PCLNR/L-Kr 95°		D30			
PSKNR/L-Kr 75°		D32			
SCLCR/L-Kr 95°		D33			

## ◎ 设计特点 | Design Features

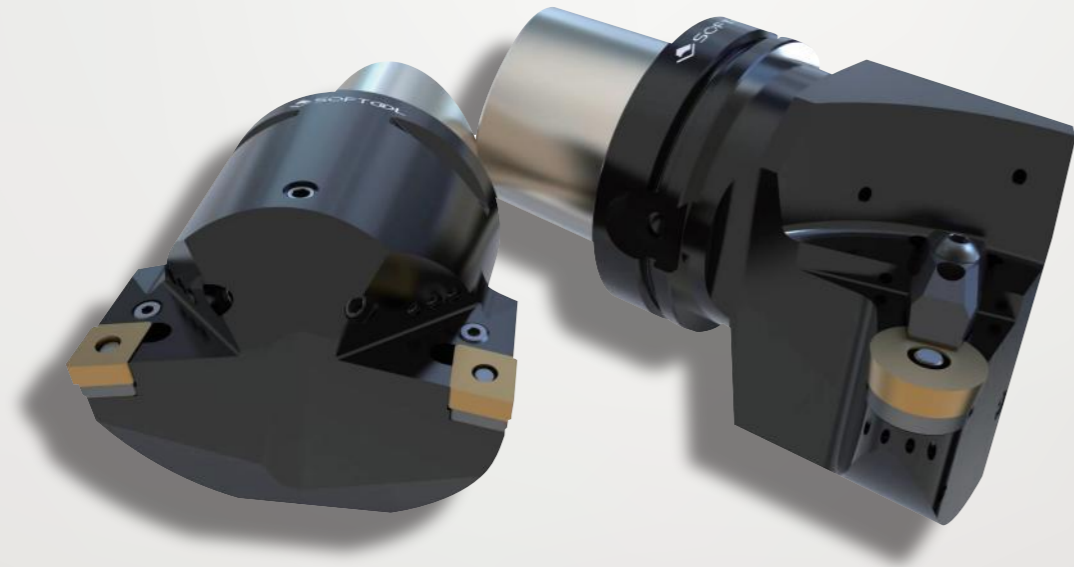

PSC接口为1:20的三棱短锥，双向定位，刚性好，传扭能力强

PSC interface is a 1:20 polygon short taper holder with bidirectional positioning, good rigidity and strong torque transmission ability.

### 您的收益

- 轴径双向定位，减震效果明显，保证工件光洁度；
- 传扭能力强，可实现重载切削，节省加工时间。

### Benefit

- Bidirectional positioning of shaft and diameter, obvious damping effect, to ensure the workpiece finish;
- Strong torque transmission capability, to realize heavy load cutting and save processing time.



通过180°旋转接纳器，可实现左右车刀具互换

Through the 180° rotation receiver, the left and right turning tools can be interchanged.

### 您的收益

- 左右手刀具可以互换使用，减少刀具及夹具的库存成本；
- 可用于老旧机床改造，实现自动化生产，降低人工成本；
- 可配合转接柄使用，实现不同接口的装夹使用，降低由于接口不通装产生的刀具采购成本。

### Benefit

- The left and right hand tools can be used interchangeably to reduce the inventory cost of tools and fixtures;
- It can be used to transform old machine tools, realize automatic production and reduce labor cost;
- It can be used with the adapter handle to realize the clamping of different interfaces and reduce the cost of tool procurement due to incompatibility of interfaces.

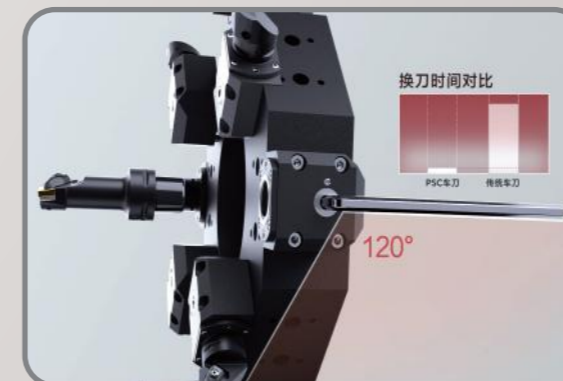

换刀装夹重复定位精度高达0.002mm，刀具松紧方式简单易操作

The repeated positioning accuracy of tool changing and clamping is up to 0.002mm, and the tool tightening is simple and easy to operate.

### 您的收益

- 相对传统车刀，无需机内对刀，减少停机等待时间；
- 提高有效加工时间25%，降低单个工件生产成本。

### Benefit

- Compared with the traditional turning tool, no need to adjust the tool in the machine and reduce the downtime;
- Increase the effective processing time by 25% and reduce the production cost of a single workpiece.



## 命名方式 | Naming And Coding Rules



## 外圆车刀体

## EXTERNAL TURNING TOOL BODY

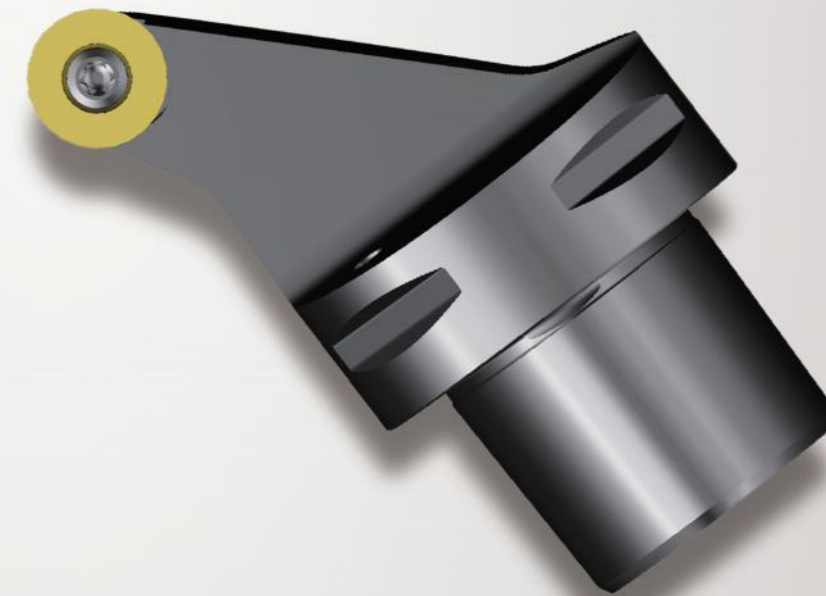

- 适用于工件外径的车削加工；
- 提供三种刀片装夹方式，可满足粗加工、半精加工及精加工等场景应用；
- 机外对刀，可用于自动化机械设备；
- 通配市场上ISO标准刀片；
- 可支持非标定制。

- For turning the external of the workpiece;
- Three clamping types, available in rough machining, semi-finishing, finishing machining;
- Out-machine tool adjustment, can be used in automatic mechanical equipment;
- Match the ISO standard insert on the market;
- Support non-standard customization.

DCLNR/L-Kr 95°

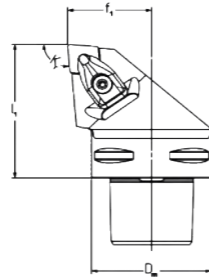
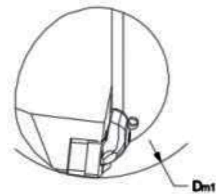

- CNMM CNMG CNMA CNGA
- 刀片仅做示意

- CNMM CNMG CNMA CNGA
- The insert is for illustration only

技术参数 | Technical parameters

单位 | Unit: mm

主偏角-加工方式 (Kr)-Application		订货号 Ordering code	Dm	Dm1	f1	l1	γ	λ	重量 m (kg)	ISO 刀片 ISO insert	
95°		PSC32-DCLNR-22045-12	32	60	22	45	-6°	-6°	0.2	CN.. 1204..	
		PSC32-DCLNL-22045-12	32	60	22	45	-6°	-6°	0.2		
		PSC40-DCLNR-27050-12	40	110	27	50	-6°	-6°	0.37		
		PSC40-DCLNL-27050-12	40	110	27	50	-6°	-6°	0.37		
		PSC50-DCLNR-35060-12	50	110	35	60	-6°	-6°	0.7		
		PSC50-DCLNL-35060-12	50	110	35	60	-6°	-6°	0.7		
		PSC63-DCLNR-45065-12	63	110	45	65	-6°	-6°	1.2		
		PSC63-DCLNL-45065-12	63	110	45	65	-6°	-6°	1.2		
		PSC80-DCLNR-55080-12	80	110	55	80	-6°	-6°	2.62		
		PSC80-DCLNL-55080-12	80	110	55	80	-6°	-6°	2.62		
		PSC40-DCLNR-27055-16	40	125	27	55	-6°	-6°	0.4		CN.. 1606..
		PSC40-DCLNL-27055-16	40	125	27	55	-6°	-6°	0.4		
		PSC50-DCLNR-35060-16	50	125	35	60	-6°	-6°	0.7		
		PSC50-DCLNL-35060-16	50	125	35	60	-6°	-6°	0.7		
		PSC63-DCLNR-45065-16	63	125	45	65	-6°	-6°	1.2		
		PSC63-DCLNL-45065-16	63	125	45	65	-6°	-6°	1.2		
PSC80-DCLNR-55080-16	80	125	55	80	-6°	-6°	2.44				
PSC80-DCLNL-55080-16	80	125	55	80	-6°	-6°	2.44				

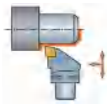

转下页 see next page →

DCLNR/L-Kr 95°

技术参数 | Technical parameters

单位 | Unit: mm

主偏角-加工方式 (Kr)-Application		订货号 Ordering code	Dm	Dm1	f1	l1	γ	λ	重量 m (kg)	ISO 刀片 ISO insert
95°		PSC50-DCLNR-35060-19	50	80	35	60	-6°	-6°	0.7	CN.. 1906..
		PSC50-DCLNL-35060-19	50	80	35	60	-6°	-6°	0.7	
		PSC63-DCLNR-45065-19	63	81	45	65	-6°	-6°	1.2	
		PSC63-DCLNL-45065-19	63	81	45	65	-6°	-6°	1.2	
		PSC80-DCLNR-55080-19	80	100	55	80	-6°	-6°	2.44	CN.. 2509..
		PSC80-DCLNL-55080-19	80	100	55	80	-6°	-6°	2.44	
		PSC80-DCLNR-55080-25	80	100	55	80	-6°	-6°	2.47	
		PSC80-DCLNL-55080-25	80	100	55	80	-6°	-6°	2.47	

主要配件 | Main spare parts

接口尺寸 PSC size	刀片 Insert	刀垫螺钉 Shim screw	刀垫 Shim	扳手 Key	整套配件 Complete clamp set
PSC32	12	ILD4085	322.236.03	248.150.10	412.028.021
PSC40-PSC80	12	ILD4085	322.234.01	248.150.10	412.028.021
PSC40-PSC80	16	ILD5011	322.234.03	248.200.10	412.028.031
PSC50-PSC80	19	ILD5011	322.236.01	248.200.10	413.028.041
PSC80	25	ILD6012	322.234.05	245.250.10	413.028.051

- 订货包含配件，不供应刀片产品
- 可单独订购配件，按需询价。

- The insert need to be ordered separately. Other accessories are included in the order.
- The spare parts can be ordered separately. Please inquire on demand.

DDJNR/L-Kr 93° DDHNR/L-Kr 107.5° DDNNN-Kr 62.5°

DDJNR/L-Kr 93° DDHNR/L-Kr 107.5° DDNNN-Kr 62.5°

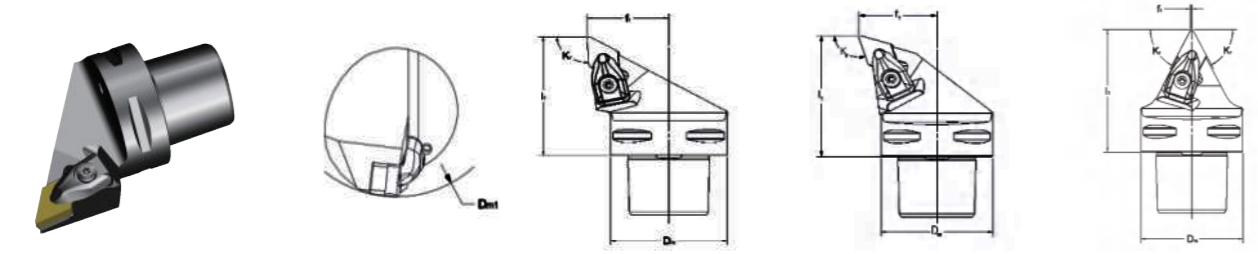

- DNMM DNMX DNMG DNMA DNMA DNMA
- 刀片仅做示意

- DNMM DNMX DNMG DNMA DNMA DNMA
- The insert is for illustration only

技术参数 | Technical parameters

单位 | Unit: mm

主偏角-加工方式 (Kr)-Application	订货号 Ordering code	Dm	Dm1	f1	l1	γ	λ	重量 m (kg)	ISO 刀片 ISO insert	
93°	11 PSC32-DDJNR-22045-11	32	60	22	45	-6°	-7°	0.19	DN.. 1104..	
	11 PSC32-DDJNL-22045-11	32	60	22	45	-6°	-7°	0.19		
	11 PSC40-DDJNR-27050-11	40	60	27	50	-6°	-7°	0.34		
	11 PSC40-DDJNL-27050-11	40	60	27	50	-6°	-7°	0.34		
	11 PSC50-DDJNR-35060-11	50	65	35	60	-6°	-7°	0.65		
	11 PSC50-DDJNL-35060-11	50	65	35	60	-6°	-7°	0.65		
	11 PSC63-DDJNR-45065-11	63	81	45	65	-6°	-7°	1.08		
	11 PSC63-DDJNL-45065-11	63	81	45	65	-6°	-7°	1.08		
	15 PSC40-DDJNR-27055-15	40	110	27	55	-6°	-7°	0.36		DN.. 1506..
	15 PSC40-DDJNL-27055-15	40	110	27	55	-6°	-7°	0.36		
	15 PSC50-DDJNR-35060-15	50	110	35	60	-6°	-7°	0.36		
	15 PSC50-DDJNL-35060-15	50	110	35	60	-6°	-7°	0.36		
	15 PSC63-DDJNR-45065-15	63	110	45	65	-6°	-7°	1.05		
	15 PSC63-DDJNL-45065-15	63	110	45	65	-6°	-7°	1.05		
15 PSC80-DDJNR-55080-15	80	110	55	80	-6°	-7°	2.16			
15 PSC80-DDJNL-55080-15	80	110	55	80	-6°	-7°	2.16			

转下页 see next page →

技术参数 | Technical parameters

单位 | Unit: mm

主偏角-加工方式 (Kr)-Application	订货号 Ordering code	Dm	Dm1	f1	l1	γ	λ	重量 m (kg)	ISO 刀片 ISO insert
107.5°	15 PSC40-DDHNR-27055-15	40	110	27	55	-6°	-7°	0.38	DN.. 1506..
	15 PSC40-DDHNL-27055-15	40	110	27	55	-6°	-7°	0.38	
	15 PSC50-DDHNR-35060-15	50	110	35	60	-6°	-7°	0.66	
	15 PSC50-DDHNL-35060-15	50	110	35	60	-6°	-7°	0.66	
	15 PSC63-DDHNR-45065-15	63	110	45	65	-6°	-7°	1.15	
	15 PSC63-DDHNL-45065-15	63	110	45	65	-6°	-7°	1.15	
	15 PSC80-DDHNR-55080-15	80	110	55	80	-6°	-7°	2.36	
	15 PSC80-DDHNL-55080-15	80	110	55	80	-6°	-7°	2.36	
62.5°	15 PSC40-DDNNN-00055-15	40	-	0.5	55	-5°	-9°	0.38	DN.. 1506..
	15 PSC50-DDNNN-00060-15	50	-	0.5	60	-5°	-9°	0.62	
	15 PSC63-DDNNN-00065-15	63	-	0.5	65	-5°	-9°	1.06	
	15 PSC80-DDNNN-00080-15	80	-	0.5	80	-5°	-9°	2.1	

主要配件 | Main spare parts

接口尺寸 PSC size	刀片 Insert	刀垫螺钉 Shim screw	刀垫 Shim	扳手 Key	整套配件 Complete clamp set
PSC32-PSC63	11	ILD3072	322.267.01	242.090.40	412.028.011
PSC40-PSC80	15	ILD4085	322.266.02	248.150.10	412.028.021

- 订货包含配件，不供应刀片产品
- 可单独订购配件，按需询价。

- The insert need to be ordered separately. Other accessories are included in the order.
- The spare parts can be ordered separately. Please inquire on demand.



DSKNR/L-Kr 75° DSDNN-Kr 45° DSSNR/L-Kr 45°

DSKNR/L-Kr 75° DSDNN-Kr 45° DSSNR/L-Kr 45°

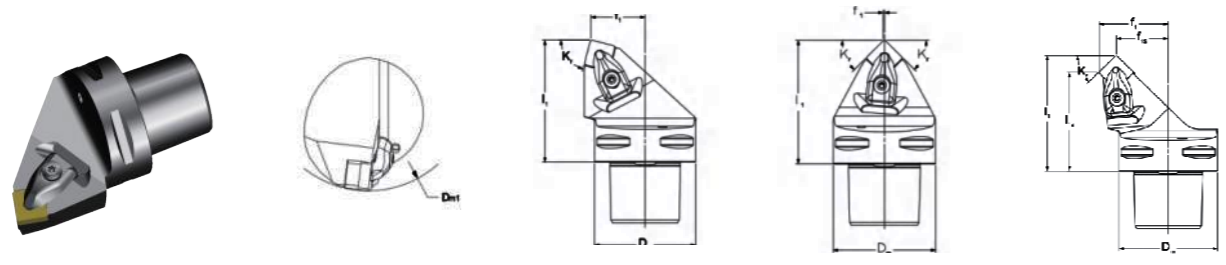

- SNMM SNMG SNMA SNGA
- 刀片仅做示意

- SNMM SNMG SNMA SNGA
- The insert is for illustration only

技术参数 | Technical parameters

单位 | Unit: mm

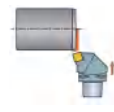
主偏角-加工方式 (Kr)-Application	订货号 Ordering code	Dm	Dm1	f1	l1	f1s	l1s	γ	λ	重量 m (kg)	ISO 刀片 ISO insert
75° 	12 PSC32-DSKNR-22040-12	32	60	22	40	-	-	-6°	-6°	0.2	SN.. 1204..
	12 PSC32-DSKNL-22040-12	32	60	22	40	-	-	-6°	-6°	0.2	
	12 PSC40-DSKNR-27050-12	40	110	27	50	-	-	-6°	-6°	0.35	
	12 PSC40-DSKNL-27050-12	40	110	27	50	-	-	-6°	-6°	0.35	
	12 PSC50-DSKNR-35060-12	50	110	35	60	-	-	-6°	-6°	0.75	
	12 PSC50-DSKNL-35060-12	50	110	35	60	-	-	-6°	-6°	0.75	
	12 PSC63-DSKNR-45065-12	63	110	45	65	-	-	-6°	-6°	1.24	SN.. 1906..
	12 PSC63-DSKNL-45065-12	63	110	45	65	-	-	-6°	-6°	1.24	
	19 PSC50-DSKNR-35060-19	50	125	35	60	-	-	-6°	-6°	0.76	
	19 PSC50-DSKNL-35060-19	50	125	35	60	-	-	-6°	-6°	0.76	
	19 PSC63-DSKNR-45065-19	63	125	45	65	-	-	-6°	-6°	1.27	
	19 PSC63-DSKNL-45065-19	63	125	45	65	-	-	-6°	-6°	1.27	
19 PSC80-DSKNR-55080-19	80	125	55	80	-	-	-6°	-6°	2.54		
19 PSC80-DSKNL-55080-19	80	125	55	80	-	-	-6°	-6°	2.54		

转下页 see next page →

技术参数 | Technical parameters

单位 | Unit: mm

主偏角-加工方式 (Kr)-Application	订货号 Ordering code	Dm	Dm1	f1	l1	f1s	l1s	γ	λ	重量 m (kg)	ISO 刀片 ISO insert
45° 	12 PSC32-DSDNN-00048-12	32	-	0.3	48	-	-	-6°	-6°	0.19	SN.. 1204..
	12 PSC40-DSDNN-00050-12	40	-	0.3	50	-	-	-6°	-6°	0.32	
	12 PSC50-DSDNN-00060-12	50	-	0.3	60	-	-	-6°	-6°	0.61	
	12 PSC63-DSDNN-00065-12	63	-	0.3	65	-	-	-6°	-6°	1.07	
45° 	12 PSC32-DSSNR-22040-12	32	60	22	40	13.7	48.3	-8°	0°	0.19	SN.. 1204..
	12 PSC32-DSSNL-22040-12	32	60	22	40	13.7	48.3	-8°	0°	0.19	
	12 PSC40-DSSNR-27042-12	40	110	27	42	18.7	50.3	-8°	0°	0.31	
	12 PSC40-DSSNL-27042-12	40	110	27	42	18.7	50.3	-8°	0°	0.31	
	12 PSC50-DSSNR-35052-12	50	110	35	52	26.7	60.3	-8°	0°	0.6	
	12 PSC50-DSSNL-35052-12	50	110	35	52	26.7	60.3	-8°	0°	0.6	
	12 PSC63-DSSNR-45056-12	63	110	45	56	36.7	64.3	-8°	0°	0.99	
	12 PSC63-DSSNL-45056-12	63	110	45	56	36.7	64.3	-8°	0°	0.99	

主要配件 | Main spare parts

接口尺寸 PSC size	刀片 Insert	刀垫螺钉 Shim screw	刀垫 Shim	扳手 Key	整套配件 Complete clamp set
PSC32	12	ILD4085	322.426.02	248.150.10	412.028.021
PSC40-PSC63	12	ILD4085	322.425.01	248.150.10	412.028.021
PSC50-PSC80	19	ILD5011	322.425.04	248.200.10	412.028.041

- 订货包含配件，不供应刀片产品
- 可单独订购配件，按需询价。

- The insert need to be ordered separately. Other accessories are included in the order.
- The spare parts can be ordered separately. Please inquire on demand.

DWLNR/L-Kr 95°

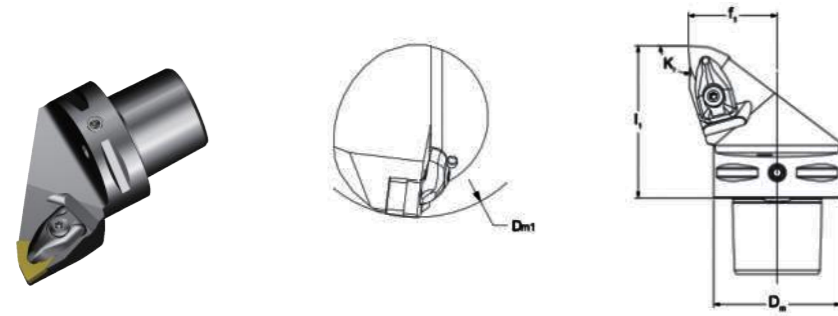

- WNMM WNMG WNGA WNMA
- 刀片仅做示意

- WNMM WNMG WNGA WNMA
- The insert is for illustration only

技术参数 | Technical parameters

单位 | Unit: mm

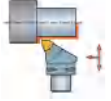
主偏角-加工方式 (Kr)-Application		订货号 Ordering code	Dm	Dm1	f1	l1	γ	λ	重量 m (kg)	ISO 刀片 ISO insert
95° 	06	PSC32-DWLNR-22040-06	32	60	22	40	-6°	-6°	0.18	WN.. 0604..
	06	PSC32-DWLNL-22040-06	32	60	22	40	-6°	-6°	0.18	
	06	PSC40-DWLNR-27050-06	40	60	27	50	-6°	-6°	0.35	
	06	PSC40-DWLNL-27050-06	40	60	27	50	-6°	-6°	0.35	
	06	PSC50-DWLNR-35060-06	50	65	35	60	-6°	-6°	0.67	
	06	PSC50-DWLNL-35060-06	50	65	35	60	-6°	-6°	0.67	
	06	PSC63-DWLNR-45065-06	63	81	45	65	-6°	-6°	1.21	
	06	PSC63-DWLNL-45065-06	63	81	45	65	-6°	-6°	1.21	

转下页 see next page →







DWLNR/L-Kr 95°

技术参数 | Technical parameters

单位 | Unit: mm

主偏角-加工方式 (Kr)-Application		订货号 Ordering code	Dm	Dm1	f1	l1	γ	λ	重量 m (kg)	ISO 刀片 ISO insert
95° 	08	PSC40-DWLNR-27050-08	40	110	27	50	-6°	-6°	0.35	WN.. 0804..
	08	PSC40-DWLNL-27050-08	40	110	27	50	-6°	-6°	0.35	
	08	PSC50-DWLNR-35060-08	50	110	35	60	-6°	-6°	0.67	
	08	PSC50-DWLNL-35060-08	50	110	35	60	-6°	-6°	0.67	
	08	PSC63-DWLNR-45065-08	63	110	45	65	-6°	-6°	1.22	
	08	PSC63-DWLNL-45065-08	63	110	45	65	-6°	-6°	1.22	
	08	PSC80-DWLNR-55080-08	80	110	55	80	-6°	-6°	2.44	
	08	PSC80-DWLNL-55080-08	80	110	55	80	-6°	-6°	2.44	

主要配件 | Main spare parts

接口尺寸 PSC size	刀片 Insert	刀垫螺钉 Shim screw	刀垫 Shim	扳手 Key	整套配件 Complete clamp set
					
PSC32-PSC63	06	ILD3072	322.328.01	242.090.40	412.028.011
PSC40-PSC80	08	ILD4085	322.331.12	248.150.10	412.028.021

- 订货包含配件，不供应刀片产品
- 可单独订购配件，按需询价。

- The insert need to be ordered seperately. Other accessories are included in the order.
- The spare parts can be ordered separately. Please inquire on demand.

DVJNR/L-Kr 93° DVVNN/L-Kr 72.5°

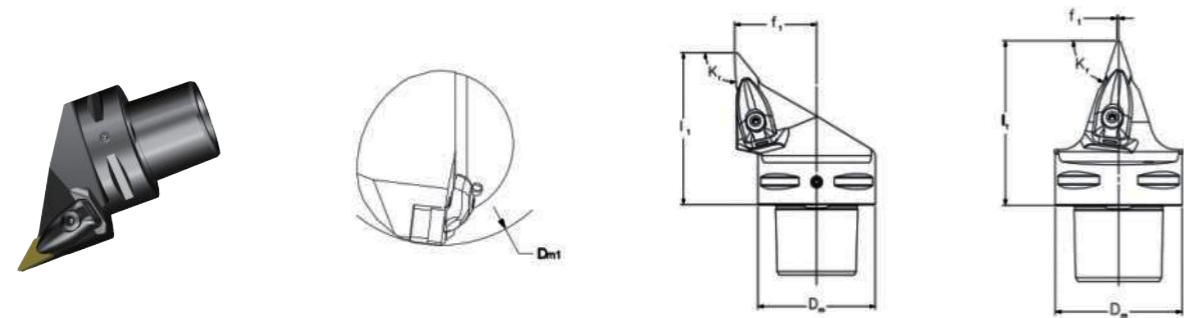

- VNMG VNGP
- 刀片仅做示意

- VNMG VNGP
- The insert is for illustration only

DTJNR/L-Kr 93°

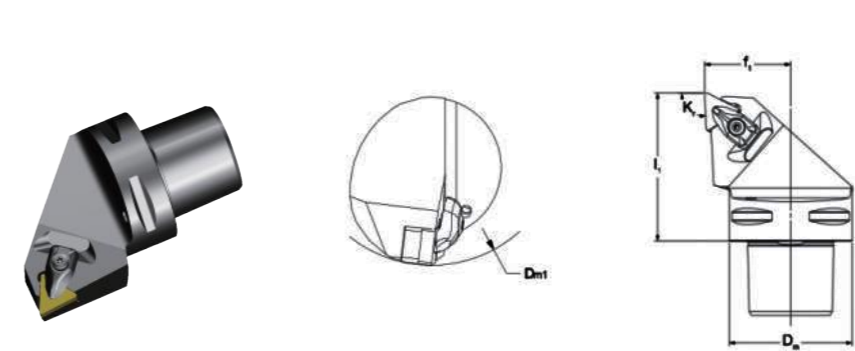

- TNMM TNMX TNMG TNMA TNGA
- 刀片仅做示意

- TNMM TNMX TNMG TNMA TNGA
- The insert is for illustration only

技术参数 | Technical parameters

单位 | Unit: mm

主偏角-加工方式 (Kr)-Application	订货号 Ordering code	Dm	Dm1	f1	l1	γ	λ	重量 m (kg)	ISO 刀片 ISO insert
93°	16 PSC40-DVJNR-27062-16	40	60	27	62	4°	-13°	0.4	VN.. 1604..
	16 PSC40-DVJNL-27062-16	40	60	27	62	4°	-13°	0.4	
	16 PSC50-DVJNR-35065-16	50	65	35	65	4°	-13°	0.65	
	16 PSC50-DVJNL-35065-16	50	65	35	65	4°	-13°	0.65	
	16 PSC63-DVJNR-45065-16	63	81	45	65	4°	-13°	1.01	
	16 PSC63-DVJNL-45065-16	63	81	45	65	4°	-13°	1.01	
	16 PSC80-DVJNR-55080-16	80	100	55	80	4°	-13°	2.1	
	16 PSC80-DVJNL-55080-16	80	100	55	80	4°	-13°	2.1	
72.5°	16 PSC40-DVVNN-00062-16	40	-	0.6	62	4°	-13°	0.41	VN.. 1604..
	16 PSC50-DVVNN-00065-16	50	-	0.6	65	4°	-13°	0.63	
	16 PSC63-DVVNN-00065-16	63	-	0.6	65	4°	-13°	1.03	
	16 PSC80-DVVNN-00080-16	80	-	0.6	80	4°	-13°	2	

主要配件 | Main spare parts

接口尺寸 PSC size	刀片 Insert	刀垫螺钉 Shim screw	刀垫 Shim	扳手 Key	整套配件 Complete clamp set
PSC40-PSC80	16	ILD3581	322.269.01	248.150.10	412.028.61

- 订货包含配件，不供应刀片产品
- 可单独订购配件，按需询价。
- The insert need to be ordered separately. Other accessories are included in the order.
- The spare parts can be ordered separately. Please inquire on demand.

技术参数 | Technical parameters

单位 | Unit: mm

主偏角-加工方式 (Kr)-Application	订货号 Ordering code	Dm	Dm1	f1	l1	γ	λ	重量 m (kg)	ISO 刀片 ISO insert
93°	16 PSC32-DTJNR-22040-16	32	60	22	40	-6°	-6°	0.2	TN.. 1604..
	16 PSC32-DTJNL-22040-16	32	60	22	40	-6°	-6°	0.2	
	16 PSC40-DTJNR-27050-16	40	110	27	50	-6°	-6°	0.43	
	16 PSC40-DTJNL-27050-16	40	110	27	50	-6°	-6°	0.43	
	16 PSC50-DTJNR-35060-16	50	110	35	60	-6°	-6°	0.78	
	16 PSC50-DTJNL-35060-16	50	110	35	60	-6°	-6°	0.78	
	16 PSC63-DTJNR-45065-16	63	110	45	65	-6°	-6°	1.34	
	16 PSC63-DTJNL-45065-16	63	110	45	65	-6°	-6°	1.34	

主要配件 | Main spare parts

接口尺寸 PSC size	刀片 Insert	刀垫螺钉 Shim screw	刀垫 Shim	扳手 Key	整套配件 Complete clamp set
PSC32	16	ILD3072	322.316.01	242.090.40	412.028.11
PSC40-PSC80	16	ILD3072	322.315.02	242.090.40	412.028.11

- 订货包含配件，不供应刀片产品
- 可单独订购配件，按需询价。
- The insert need to be ordered separately. Other accessories are included in the order.
- The spare parts can be ordered separately. Please inquire on demand.

PCLNR/L-Kr 95°

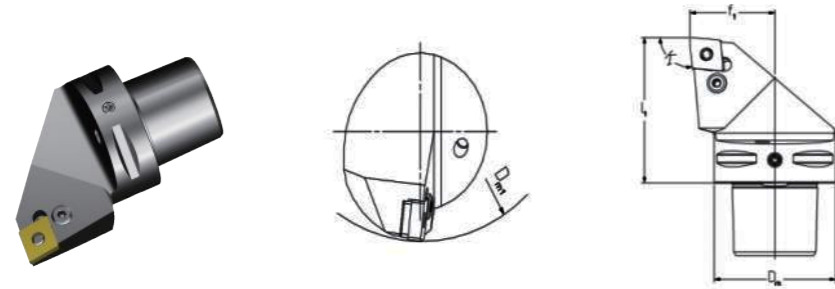

- CNMM CNMG CNMA CNGA
- 刀片仅做示意

- CNMM CNMG CNMA CNGA
- The insert is for illustration only

技术参数 | Technical parameters

单位 | Unit: mm

主偏角-加工方式 (Kr)-Application		订货号 Ordering code	Dm	f1	l1	γ	λ	重量 m (kg)	ISO 刀片 ISO insert	
95°		12	PSC40-PCLNR-27050-12	40	27	50	-6°	-6°	0.36	CN.. 1204..
		12	PSC40-PCLNL-27050-12	40	27	50	-6°	-6°	0.36	
		12	PSC50-PCLNR-35060-12	50	35	60	-6°	-6°	0.68	
		12	PSC50-PCLNL-35060-12	50	35	60	-6°	-6°	0.68	
		12	PSC63-PCLNR-45065-12	63	45	65	-6°	-6°	1.19	
		12	PSC63-PCLNL-45065-12	63	45	65	-6°	-6°	1.19	
		12	PSC80-PCLNR-55080-12	80	55	80	-6°	-6°	2.39	
		12	PSC80-PCLNL-55080-12	80	55	80	-6°	-6°	2.39	
		16	PSC40-PCLNR-27050-16	40	27	50	-6°	-6°	0.35	CN.. 1606..
		16	PSC40-PCLNL-27050-16	40	27	50	-6°	-6°	0.35	
		16	PSC50-PCLNR-35060-16	50	35	60	-6°	-6°	0.68	
		16	PSC50-PCLNL-35060-16	50	35	60	-6°	-6°	0.68	
		16	PSC63-PCLNR-45065-16	63	45	65	-6°	-6°	1.19	
		16	PSC63-PCLNL-45065-16	63	45	65	-6°	-6°	1.19	
16	PSC80-PCLNR-55080-16	80	55	80	-6°	-6°	2.39			
16	PSC80-PCLNL-55080-16	80	55	80	-6°	-6°	2.39			

转下页 see next page →

PCLNR/L-Kr 95°

技术参数 | Technical parameters

单位 | Unit: mm

主偏角-加工方式 (Kr)-Application		订货号 Ordering code	Dm	f1	l1	γ	λ	重量 m (kg)	ISO 刀片 ISO insert	
95°		19	PSC50-PCLNR-35060-19	50	35	60	-6°	-6°	0.68	CN.. 1906..
		19	PSC50-PCLNL-35060-19	50	35	60	-6°	-6°	0.68	
		19	PSC63-PCLNR-45065-19	63	45	65	-6°	-6°	1.19	
		19	PSC63-PCLNL-45065-19	63	45	65	-6°	-6°	1.19	
		19	PSC80-PCLNR-55080-19	80	55	80	-6°	-6°	2.39	
		19	PSC80-PCLNL-55080-19	80	55	80	-6°	-6°	2.39	

主要配件 | Main spare parts

接口尺寸 PSC size	刀片 Insert	刀垫螺钉 Shim screw	刀垫 Shim	扳手 Key	勾杆 Lever
PSC40-PSC63					
PSC40-PSC80	12	414.438.21	322.318.50	241.030.63	413.438.41
PSC50-PSC80	16	414.838.31	322.318.52	241.030.63	413.838.40
PSC50-PSC80	19	414.438.22	322.318.51	241.030.63	413.438.42

- 订货包含配件，不供应刀片产品
- 可单独订购配件，按需询价。

- The insert need to be ordered separately. Other accessories are included in the order.
- The spare parts can be ordered separately. Please inquire on demand.



## PDJNR/L-Kr 93°

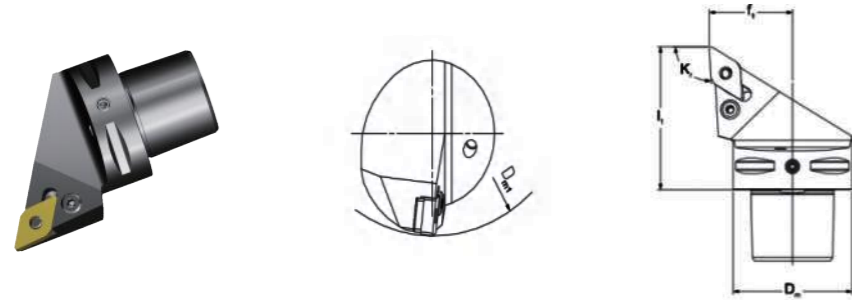

- DNMM DNMX DNMG DNMA DNGA
- 刀片仅做示意

- DNMM DNMX DNMG DNMA DNGA
- The insert is for illustration only

## PSKNR/L-Kr 75°

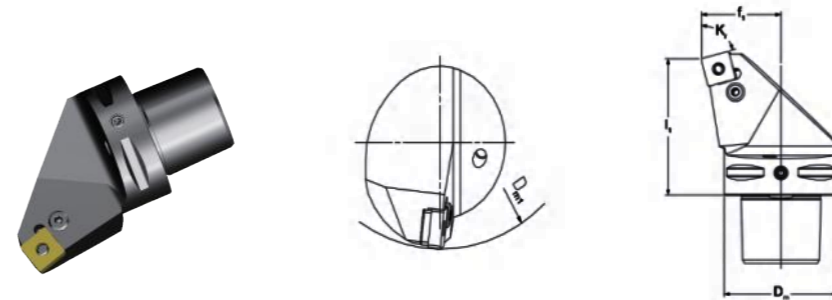

- SNMM SNMG SNMA SNGA
- 刀片仅做示意

- SNMM SNMG SNMA SNGA
- The insert is for illustration only

### 技术参数 | Technical parameters

单位 | Unit: mm

主偏角-加工方式 (Kr)-Application		订货号 Ordering code	Dm	f1	l1	γ	λ	重量 m (kg)	ISO 刀片 ISO insert
	15	PSC40-PDJNR-27055-15	40	27	55	-6°	-7°	0.36	DN.. 1506..
	15	PSC40-PDJNL-27055-15	40	27	55	-6°	-7°	0.36	
	15	PSC50-PDJNR-35060-15	50	35	60	-6°	-7°	0.62	
	15	PSC50-PDJNL-35060-15	50	35	60	-6°	-7°	0.62	
	15	PSC63-PDJNR-45065-15	63	45	65	-6°	-7°	1.05	
	15	PSC63-PDJNL-45065-15	63	45	65	-6°	-7°	1.05	

### 技术参数 | Technical parameters

单位 | Unit: mm

主偏角-加工方式 (Kr)-Application		订货号 Ordering code	Dm	f1	l1	γ	λ	重量 m (kg)	ISO 刀片 ISO insert
	12	PSC40-PSKNR-27050-12	40	27	50	-6°	-6°	0.34	SN.. 1204..
	12	PSC40-PSKNL-27050-12	40	27	50	-6°	-6°	0.34	
	12	PSC50-PSKNR-35060-12	50	35	60	-6°	-6°	0.72	
	12	PSC50-PSKNL-35060-12	50	35	60	-6°	-6°	0.72	
	12	PSC63-PSKNR-45065-12	63	45	65	-6°	-6°	1.15	
	12	PSC63-PSKNL-45065-12	63	45	65	-6°	-6°	1.15	

### 主要配件 | Main spare parts

接口尺寸 PSC size	刀片 Insert	刀垫螺钉 Shim screw	刀垫 Shim	扳手 Key	勾杆 Lever
PSC40-PSC63	15	414.438.30	322.358.51	241.030.63	413.438.47

- 订货包含配件，不供应刀片产品
- 可单独订购配件，按需询价。
- The insert need to be ordered separately. Other accessories are included in the order.
- The spare parts can be ordered separately. Please inquire on demand.

### 主要配件 | Main spare parts

接口尺寸 PSC size	刀片 Insert	刀垫螺钉 Shim screw	刀垫 Shim	扳手 Key	勾杆 Lever
PSC40-PSC63	12	414.438.21	322.438.51	241.030.63	413.438.41

- 订货包含配件，不供应刀片产品
- 可单独订购配件，按需询价。
- The insert need to be ordered separately. Other accessories are included in the order.
- The spare parts can be ordered separately. Please inquire on demand.

SCLCR/L-Kr 95°

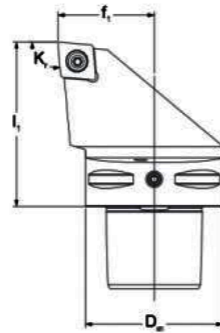

- CCMT CCGT CCGX CCET CCMW
- 刀片仅做示意

- CCMT CCGT CCGX CCET CCMW
- The insert is for illustration only

技术参数 | Technical parameters

单位 | Unit: mm

主偏角-加工方式 (Kr)-Application		订货号 Ordering code	Dm	f1	l1	γ	λ	重量 m (kg)	ISO 刀片 ISO insert
	12	PSC32-SCLCR-22040-12	32	22	40	0°	0°	0.2	CC..1204..
	12	PSC32-SCLCL-22040-12	32	22	40	0°	0°	0.2	
	12	PSC40-SCLCR-27050-12	40	27	50	0°	0°	0.44	
	12	PSC40-SCLCL-27050-12	40	27	50	0°	0°	0.44	
	12	PSC50-SCLCR-35060-12	50	35	60	0°	0°	0.77	
	12	PSC50-SCLCL-35060-12	50	35	60	0°	0°	0.77	
	12	PSC63-SCLCR-45065-12	63	45	65	0°	0°	1.34	
	12	PSC63-SCLCL-45065-12	63	45	65	0°	0°	1.34	

主要配件 | Main spare parts

接口尺寸 PSC size	刀片 Insert	刀垫螺钉 Shim screw	刀垫 Shim	扳手 Key	刀片螺钉 Insert screw
PSC32-PSC63	12	512.090.03	322.232.02	248.150.10 & 241.040.70	ILD4014

- 订货包含配件，不供应刀片产品
- 可单独订购配件，按需询价。
- The insert need to be ordered separately. Other accessories are included in the order.
- The spare parts can be ordered separately. Please inquire on demand.

SDJCR/L-Kr 93°

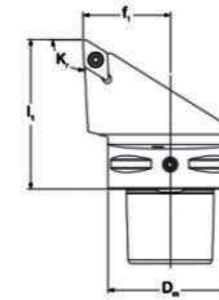

- DCMT DCMX DCGT DCGX DCET DCMW
- 刀片仅做示意

- DCMT DCMX DCGT DCGX DCET DCMW
- The insert is for illustration only

技术参数 | Technical parameters

单位 | Unit: mm

主偏角-加工方式 (Kr)-Application		订货号 Ordering code	Dm	f1	l1	γ	λ	重量 m (kg)	ISO 刀片 ISO insert
	11	PSC32-SDJCR-22040-11	32	22	40	0°	0°	0.16	DC..11T3..
	11	PSC32-SDJCL-22040-11	32	22	40	0°	0°	0.16	
	11	PSC40-SDJCR-27050-11	40	27	50	0°	0°	0.33	
	11	PSC40-SDJCL-27050-11	40	27	50	0°	0°	0.33	
	11	PSC50-SDJCR-35060-11	50	35	60	0°	0°	0.63	
	11	PSC50-SDJCL-35060-11	50	35	60	0°	0°	0.63	
	11	PSC63-SDJCR-45065-11	63	45	65	0°	0°	1.05	
	11	PSC63-SDJCL-45065-11	63	45	65	0°	0°	1.05	

主要配件 | Main spare parts

接口尺寸 PSC size	刀片 Insert	刀垫螺钉 Shim screw	刀垫 Shim	扳手 Key	刀片螺钉 Insert screw
PSC32-PSC63	11	512.090.01	322.263.01	248.150.10 & 241.035.65	ILD3512

- 订货包含配件，不供应刀片产品
- 可单独订购配件，按需询价。
- The insert need to be ordered separately. Other accessories are included in the order.
- The spare parts can be ordered separately. Please inquire on demand.

SVHBR/L-Kr 107.5° SVJBR/L-Kr 93°

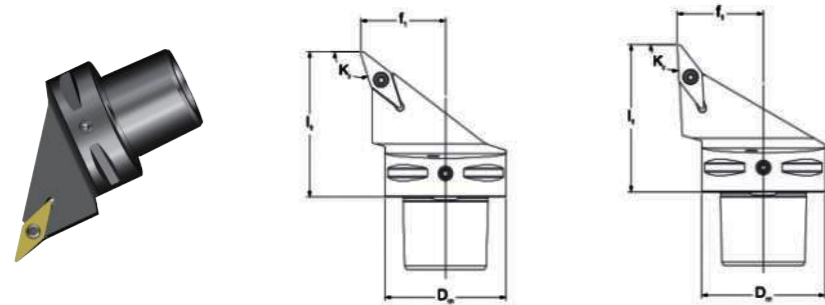

- VBMT VBGT VCGX VCEX VCGT VCET VBMW VCMW
- 刀片仅做示意

- VBMT VBGT VCGX VCEX VCGT VCET VBMW VCMW
- The insert is for illustration only

技术参数 | Technical parameters

单位 | Unit: mm

主偏角-加工方式 (Kr)-Application		订货号 Ordering code	Dm	f1	l1	γ	λ	重量 m (kg)	ISO 刀片 ISO insert
	16	PSC40-SVHBR-27050-16	40	27	50	0°	0°	0.38	VB..1604.. VC..1604..
	16	PSC40-SVHBL-27050-16	40	27	50	0°	0°	0.38	
	16	PSC50-SVHBR-35060-16	50	35	60	0°	0°	0.64	
	16	PSC50-SVHBL-35060-16	50	35	60	0°	0°	0.64	
	16	PSC63-SVHBR-45065-16	63	45	65	0°	0°	1.12	
	16	PSC63-SVHBL-45065-16	63	45	65	0°	0°	1.12	
	16	PSC40-SVJBR-27050-16	40	27	50	0°	0°	0.35	VB..1604.. VC..1604..
	16	PSC40-SVJBL-27050-16	40	27	50	0°	0°	0.35	
	16	PSC50-SVJBR-35060-16	50	35	60	0°	0°	0.7	
	16	PSC50-SVJBL-35060-16	50	35	60	0°	0°	0.7	
	16	PSC63-SVJBR-45065-16	63	45	65	0°	0°	1.11	
	16	PSC63-SVJBL-45065-16	63	45	65	0°	0°	1.11	

主要配件 | Main spare parts

接口尺寸 PSC size	刀片 Insert	刀垫螺钉 Shim screw	刀垫 Shim	扳手 Key	刀片螺钉 Insert screw
PSC32-PSC63	16	512.090.01	322.270.01	248.150.10 & 241.035.65	ILD3512

- 订货包含配件，不供应刀片产品
- 可单独订购配件，按需询价。
- The insert need to be ordered separately. Other accessories are included in the order.
- The spare parts can be ordered separately. Please inquire on demand.

SRDCN SRSCR/L

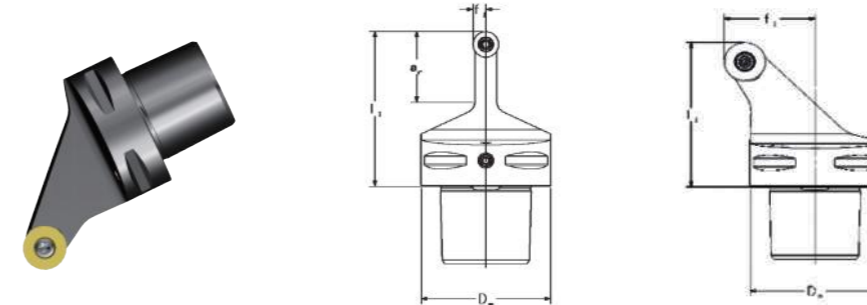

- RCMT RCGX-AL
- 刀片仅做示意

- RCMT RCGX-AL
- The insert is for illustration only

技术参数 | Technical parameters

单位 | Unit: mm

主偏角-加工方式 (Kr)-Application		订货号 Ordering code	Dm	ar	f1	l1	γ	λ	重量 m (kg)	ISO 刀片 ISO insert
	10	PSC32-SRDCN-00040-10A	32	20	5	40	0°	0°	0.13	RC.10T3M0
	10	PSC40-SRDCN-00050-10A	40	25	5	50	0°	0°	0.27	
	10	PSC50-SRDCN-00060-10A	50	25	5	60	0°	0°	0.51	
	10	PSC63-SRDCN-00065-10A	63	25	5	65	0°	0°	0.91	
	16	PSC50-SRSCR-35060-16	50	-	35	60	0°	0°	0.56	RC.1606M0
	16	PSC50-SRSCS-35060-16	50	-	35	60	0°	0°	0.56	
	16	PSC63-SRSCR-45065-16	63	-	45	65	0°	0°	1.03	
16	PSC63-SRSCS-45065-16	63	-	45	65	0°	0°	1.03		

主要配件 | Main spare parts

接口尺寸 PSC size	刀片 Insert	刀垫螺钉 Shim screw	刀垫 Shim	扳手 Key	刀片螺钉 Insert screw
PSC32-PSC63	10	512.090.01	322.110.01	248.150.10 & 251.035.65	ILD3510
PSC50-PSC63	16	512.090.06	322.110.03	248.200.10 & 241.050.80	ILD5017

- 订货包含配件，不供应刀片产品
- 可单独订购配件，按需询价。
- The insert need to be ordered separately. Other accessories are included in the order.
- The spare parts can be ordered separately. Please inquire on demand.

### 内圆车刀体

### INTERNAL TURNING TOOL BODY



- 适用于工件内径的车削加工;
- 标准车刀体长度最大可做到140mm;
- 机外对刀, 可用于自动化生产设备;
- 通配市场上ISO标准刀片;
- 可支持非标定制。

- For turning the internal of the workpiece;
- The maximum length of standard turning tool body can be 140mm;
- Out-machine tool adjustment, can be used in automatic mechanical equipment;
- Match the ISO standard insert on the market;
- Support non-standard customization.

### DCLNR/L-Kr 95°

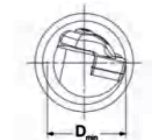
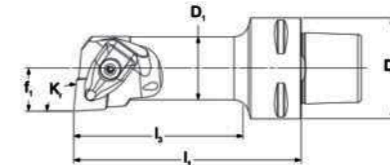

- CNMM CNMG CNMA CNGA
- 刀片仅做示意

- CNMM CNMG CNMA CNGA
- The insert is for illustration only

#### 技术参数 | Technical parameters

单位 | Unit: mm

主偏角-加工方式 (Kr)-Application	订货号 Ordering code	Dm	Dmin	D1	f1	l1	l3	γ	λ	重量 m (kg)	ISO 刀片 ISO insert
	12 PSC40-DCLNR-17090-12	40	32	25	17	90	69	-6°	-12°	0.47	CN.. 1204..
	12 PSC40-DCLNL-17090-12	40	32	25	17	90	69	-6°	-12°	0.47	
	12 PSC50-DCLNR-17090-12	50	32	25	17	90	67	-6°	-12°	0.65	
	12 PSC50-DCLNL-17090-12	50	32	25	17	90	67	-6°	-12°	0.65	
	12 PSC63-DCLNR-17100-12	63	32	25	17	100	73	-6°	-12°	1.04	
	12 PSC63-DCLNL-17100-12	63	32	25	17	100	73	-6°	-12°	1.04	

#### 主要配件 | Main spare parts

接口尺寸 PSC size	刀片 Insert	刀垫螺钉 Shim screw	刀垫 Shim	扳手 Key	整套配件 Complete clamp set
PSC40-PSC63	12	ILD4085	322.236.03	248.150.10	412.028.021

- 订货包含配件, 不供应刀片产品
- 可单独订购配件, 按需询价。

- The insert need to be ordered separately. Other accessories are included in the order.
- The spare parts can be ordered separately. Please inquire on demand.



DDUNR/L-Kr 93°

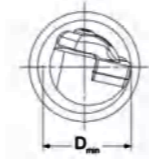
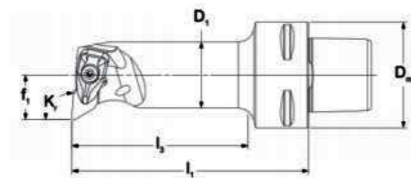
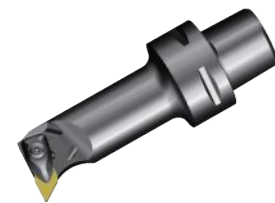

- DNMM DNMX DNMG DNMA DNGA
- 刀片仅做示意

- DNMM DNMX DNMG DNMA DNGA
- The insert is for illustration only

技术参数 | Technical parameters

单位 | Unit: mm

主偏角-加工方式 (Kr)-Application		订货号 Ordering code	Dm	Dmin	D1	f1	l1	l3	γ	λ	重量 m (kg)	ISO 刀片 ISO insert
	11	PSC40-DDUNR-17090-11	40	32	25	17	90	68	-6°	-12°	0.47	DN.. 1104..
	11	PSC40-DDUNL-17090-11	40	32	25	17	90	68	-6°	-12°	0.47	
	11	PSC50-DDUNR-17090-11	50	32	25	17	90	66	-6°	-12°	0.65	
	11	PSC50-DDUNL-17090-11	50	32	25	17	90	66	-6°	-12°	0.65	
	15	PSC40-DDUNR-27080-15	40	50	39.7	27	80	59	-6°	-11°	1.04	DN.. 1506..
	15	PSC40-DDUNL-27080-15	40	50	39.7	27	80	59	-6°	-11°	1.04	
	15	PSC50-DDUNR-27140-15	50	50	40	27	140	118	-6°	-11°	1.04	
	15	PSC50-DDUNL-27140-15	50	50	40	27	140	118	-6°	-11°	1.04	
	15	PSC63-DDUNR-27140-15	63	50	40	27	140	114	-6°	-11°	1.04	
	15	PSC63-DDUNL-27140-15	63	50	40	27	140	114	-6°	-11°	1.04	

主要配件 | Main spare parts

接口尺寸 PSC size	刀片 Insert	刀垫螺钉 Shim screw	刀垫 Shim	扳手 Key	整套配件 Complete clamp set
PSC40-PSC50	11	ILD3072	322.267.01	242.090.40	412.028.011
PSC40-PSC63	15	ILD4085	322.266.02	248.150.10	412.028.021

- 订货包含配件，不供应刀片产品
- 可单独订购配件，按需询价。

- The insert need to be ordered separately. Other accessories are included in the order.
- The spare parts can be ordered separately. Please inquire on demand.

DWLNR/L-Kr 95°

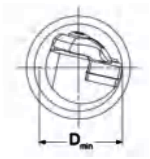
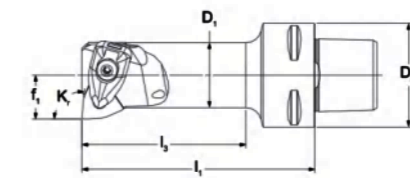

- WNMM WNMG WNGA WNMA
- 刀片仅做示意

- WNMM WNMG WNGA WNMA
- The insert is for illustration only

技术参数 | Technical parameters

单位 | Unit: mm

主偏角-加工方式 (Kr)-Application		订货号 Ordering code	Dm	Dmin	D1	f1	l1	l3	γ	λ	重量 m (kg)	ISO 刀片 ISO insert
	08	PSC40-DWLNR-17090-08	40	32	25	17	90	69	-0°	-6°	0.48	WN.. 0804..
	08	PSC40-DWLNL-17090-08	40	32	25	17	90	69	-0°	-6°	0.48	
	08	PSC50-DWLNR-17090-08	50	32	25	17	90	69	-0°	-6°	0.67	
	08	PSC50-DWLNL-17090-08	50	32	25	17	90	69	-0°	-6°	0.67	

主要配件 | Main spare parts

接口尺寸 PSC size	刀片 Insert	刀垫螺钉 Shim screw	刀垫 Shim	扳手 Key	整套配件 Complete clamp set
PSC40-PSC50	08	ILD4085	322.328.02	248.150.10	412.028.021

- 订货包含配件，不供应刀片产品
- 可单独订购配件，按需询价。

- The insert need to be ordered separately. Other accessories are included in the order.
- The spare parts can be ordered separately. Please inquire on demand.

PCLNR/L-Kr 95°

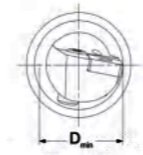
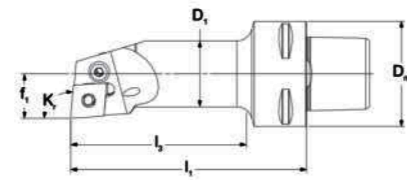

- CNMM CNMG CNMA CNGA
- 刀片仅做示意

- CNMM CNMG CNMA CNGA
- The insert is for illustration only

技术参数 | Technical parameters

单位 | Unit: mm

主偏角-加工方式 (Kr)-Application	订货号 Ordering code	Dm	Dmin	D1	f1	l1	l3	γ	λ	重量 m (kg)	ISO 刀片 ISO insert
95°	12 PSC32-PCLNR-17090-12	32	32	25	17	90	75	-6°	-11°	0.3	CN.. 1204..
	12 PSC32-PCLNL-17090-12	32	32	25	17	90	75	-6°	-11°	0.3	
	12 PSC32-PCLNR-22064-12	32	40	32	22	64	50	-6°	-11°	0.3	
	12 PSC32-PCLNL-22064-12	32	40	32	22	64	50	-6°	-11°	0.3	
	12 PSC32-PCLNR-22096-12	32	40	32	22	96	82	-6°	-11°	0.3	
	12 PSC32-PCLNL-22096-12	32	40	32	22	96	82	-6°	-11°	0.3	
	12 PSC40-PCLNR-17090-12	40	32	25	17	90	69	-6°	-11°	0.5	
	12 PSC40-PCLNL-17090-12	40	32	25	17	90	69	-6°	-11°	0.5	
	12 PSC40-PCLNR-22110-12	40	40	32	22	110	89	-6°	-11°	0.5	
	12 PSC40-PCLNL-22110-12	40	40	32	22	110	89	-6°	-11°	0.5	
	12 PSC40-PCLNR-27080-12	40	50	40	27	80	60	-6°	-10°	0.5	
	12 PSC40-PCLNL-27080-12	40	50	40	27	80	60	-6°	-10°	0.5	
	12 PSC40-PCLNR-27120-12	40	50	40	27	120	100	-6°	-11°	0.5	
	12 PSC40-PCLNL-27120-12	40	50	40	27	120	100	-6°	-11°	0.5	

转下页 see next page →

PCLNR/L-Kr 95°

技术参数 | Technical parameters

单位 | Unit: mm

主偏角-加工方式 (Kr)-Application	订货号 Ordering code	Dm	Dmin	D1	f1	l1	l3	γ	λ	重量 m (kg)	ISO 刀片 ISO insert
95°	12 PSC50-PCLNR-17090-12	50	32	25	17	90	67	-6°	-11°	0.65	CN.. 1204..
	12 PSC50-PCLNL-17090-12	50	32	25	17	90	67	-6°	-11°	0.65	
	12 PSC50-PCLNR-22110-12	50	40	32	22	110	88	-6°	-11°	0.66	
	12 PSC50-PCLNL-22110-12	50	40	32	22	110	88	-6°	-11°	0.66	
	12 PSC50-PCLNR-27140-12	50	50	40	27	140	119	-6°	-10°	0.67	
	12 PSC50-PCLNL-27140-12	50	50	40	27	140	119	-6°	-10°	0.67	
	12 PSC50-PCLNR-35100-12	50	63	50	35	100	81	-6°	-7°	0.68	
	12 PSC50-PCLNL-35100-12	50	63	50	35	100	81	-6°	-7°	0.68	
	12 PSC63-PCLNR-17100-12	63	32	25	17	100	74	-6°	-11°	1	
	12 PSC63-PCLNL-17100-12	63	32	25	17	100	74	-6°	-11°	1	
	12 PSC63-PCLNR-22110-12	63	40	32	22	110	84	-6°	-11°	1.2	
	12 PSC63-PCLNL-22110-12	63	40	32	22	110	84	-6°	-11°	1.2	

主要配件 | Main spare parts

接口尺寸 PSC size	刀片 Insert	螺钉 Screw	刀垫 Shim	扳手 Key	勾杆 Lever
PSC32-PSC63(D25)	12	414.838.32	-	241.025.56	413.838.41-1
PSC32-PSC63(D32-D50)	12	414.438.21	322.318.50	241.030.63	413.438.41

- 订货包含配件，不供应刀片产品
- 可单独订购配件，按需询价。

- The insert need to be ordered separately. Other accessories are included in the order.
- The spare parts can be ordered separately. Please inquire on demand.

PSKNR/L-Kr 75°

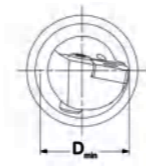
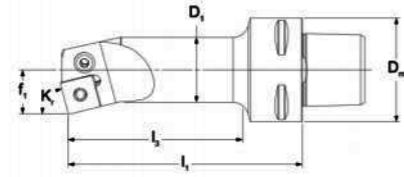
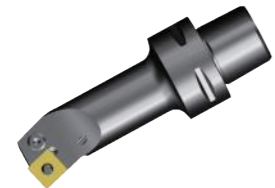

- SNMM SNMG SNMA SNGA
- 刀片仅做示意

- SNMM SNMG SNMA SNGA
- The insert is for illustration only

技术参数 | Technical parameters

单位 | Unit: mm

主偏角-加工方式 (Kr)-Application		订货号 Ordering code	Dm	Dmin	D1	f1	l1	l3	γ	λ	重量 m (kg)	ISO 刀片 ISO insert
	12	PSC40-PSKNR-17090-12	40	32	25	17	90	69	-6°	-11°	0.45	SN..1204..
	12	PSC50-PSKNR-17090-12	50	32	25	17	90	67	-6°	-11°	0.51	
	12	PSC50-PSKNR-22110-12	50	40	32	22	110	88	-6°	-10°	0.7	
	12	PSC50-PSKNR-27140-12	50	50	40	27	140	119	-6°	-10°	1.4	
	12	PSC63-PSKNR-22110-12	63	40	32	22	110	84	-6°	-10°	1.3	

主要配件 | Main spare parts

接口尺寸 PSC size	刀片 Insert	螺钉 Screw	刀垫 Shim	扳手 Key	勾杆 Lever
PSC40-PSC50(D25)	12	414.838.32	-	241.025.56	413.838.41-1
PSC50-PSC63(D32-D40)	12	414.438.21	322.438.51	241.030.63	413.438.41

- 订货包含配件，不供应刀片产品
- 可单独订购配件，按需询价。
- The insert need to be ordered seperately. Other accessories are included in the order.
- The spare parts can be ordered separately. Please inquire on demand.

SCLCR/L-Kr 95°

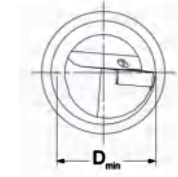
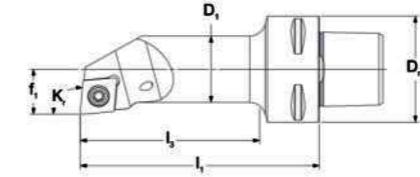
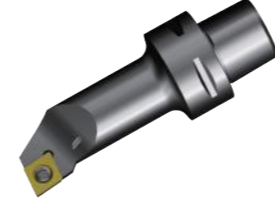

- CCMT CCGT CCGX CCET CCMW
- 刀片仅做示意

- CCMT CCGT CCGX CCET CCMW
- The insert is for illustration only

技术参数 | Technical parameters

单位 | Unit: mm

主偏角-加工方式 (Kr)-Application		订货号 Ordering code	Dm	Dmin	D1	f1	l1	l3	γ	λ	重量 m (kg)	ISO 刀片 ISO insert
	12	PSC32-SCLCR-17090-12	32	32	25	17	90	75	0°	-6°	0.32	CC..1204..
	12	PSC32-SCLCL-17090-12	32	32	25	17	90	75	0°	-6°	0.32	
	12	PSC32-SCLCR-22064-12	32	40	31.7	22	64	50	0°	-10°	0.31	
	12	PSC32-SCLCL-22064-12	32	40	31.7	22	64	50	0°	-10°	0.31	
	12	PSC32-SCLCR-22090-12	32	40	31.7	22	90	82	0°	-10°	0.5	
	12	PSC32-SCLCL-22090-12	32	40	31.7	22	90	82	0°	-10°	0.5	
	12	PSC40-SCLCR-17090-12	40	32	25	17	90	69	0°	-6°	0.45	
	12	PSC40-SCLCL-17090-12	40	32	25	17	90	69	0°	-6°	0.45	
	12	PSC40-SCLCR-22110-12	40	40	32	22	110	89	0°	-10°	0.68	
	12	PSC40-SCLCL-22110-12	40	40	32	22	110	89	0°	-10°	0.68	
	12	PSC40-SCLCR-27080-12	40	50	39.7	27	80	60	0°	-8°	0.63	
	12	PSC40-SCLCL-27080-12	40	50	39.7	27	80	60	0°	-8°	0.63	

转下页 see next page →

## SCLCR/L-Kr 95°

### 技术参数 | Technical parameters

单位 | Unit: mm

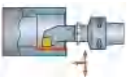
主偏角-加工方式 (Kr)-Application	订货号 Ordering code	Dm	Dmin	D1	f1	l1	l3	γ	λ	重量 m (kg)	ISO 刀片 ISO insert	
	12	PSC50-SCLCR-17090-12	50	32	25	17	90	67	0°	-6°	0.63	CC..1204..
	12	PSC50-SCLCL-17090-12	50	32	25	17	90	67	0°	-6°	0.63	
	12	PSC50-SCLCR-22110-12	50	40	32	22	110	88	0°	-10°	0.87	
	12	PSC50-SCLCL-22110-12	50	40	32	22	110	88	0°	-10°	0.87	
	12	PSC50-SCLCR-27140-12	50	50	40	27	140	119	0°	-8°	1.35	
	12	PSC50-SCLCL-27140-12	50	50	40	27	140	119	0°	-8°	1.35	
	12	PSC50-SCLCR-35100-12	50	63	49.7	35	100	80	0°	-5°	1.27	
	12	PSC50-SCLCL-35100-12	50	63	49.7	35	100	80	0°	-5°	1.27	

### 主要配件 | Main spare parts

接口尺寸 PSC size	刀片 Insert	刀垫螺钉 Shim screw	刀垫 Shim	扳手 Key	刀片螺钉 Insert screw
PSC32-PSC50(D25)	12	-	-	248.150.10	ILD4011-A
PSC32-PSC50(D32-D40)	12	512.090.03	322.232.02	248.150.10 & 241.040.70	ILD4014

- 订货包含配件，不供应刀片产品
- 可单独订购配件，按需询价。

- The insert need to be ordered seperately. Other accessories are included in the order.
- The spare parts can be ordered separately. Please inquire on demand.

## SDUCR/L-Kr 93°

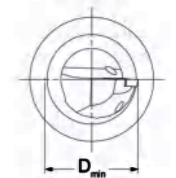
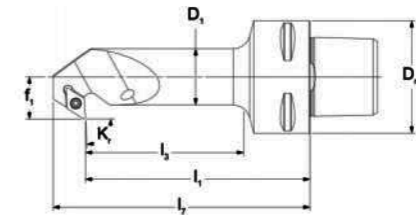
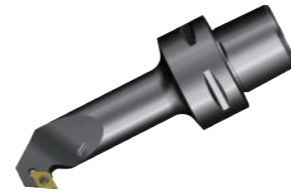

- DCMT DCMX DCGT DCGX DCET DCMW
- 刀片仅做示意

- DCMT DCMX DCGT DCGX DCET DCMW
- The insert is for illustration only

### 技术参数 | Technical parameters

单位 | Unit: mm

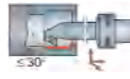
主偏角-加工方式 (Kr)-Application	订货号 Ordering code	Dm	Dmin	D1	f1	l1	l3	l7	γ	λ	重量 m (kg)	ISO 刀片 ISO insert	
	07	PSC32-SDUCR-13070-07X	32	22	16	13	70	54	0°	-6°	0.19	DC.. 0702..	
	07	PSC32-SDUCL-13070-07X	32	22	16	13	70	54	0°	-6°	0.19		
	07	PSC32-SDUCR-15080-07X	32	27	20	15	80	64	91.5	0°	-3°		0.26
	07	PSC32-SDUCL-15080-07X	32	27	20	15	80	64	91.5	0°	-3°		0.26
	07	PSC40-SDUCR-13070-07X	40	22	16	13	70	48	80.7	0°	-6°		0.32
	07	PSC40-SDUCL-13070-07X	40	22	16	13	70	48	80.7	0°	-6°		0.32
	07	PSC40-SDUCR-15080-07X	40	27	20	15	80	58	91.5	0°	-3°		0.39
	07	PSC40-SDUCL-15080-07X	40	27	20	15	80	58	91.5	0°	-3°		0.39
	07	PSC40-SDUCR-18090-07X	40	32	25	18	90	69	101.5	0°	-3°		0.49
	07	PSC40-SDUCL-18090-07X	40	32	25	18	90	69	101.5	0°	-3°		0.49
	07	PSC50-SDUCR-15080-07X	50	27	20	15	80	58	91.5	0°	-3°		0.58
	07	PSC50-SDUCL-15080-07X	50	27	20	15	80	58	91.5	0°	-3°		0.58
	07	PSC50-SDUCR-18090-07X	50	32	25	18	90	68	101.5	0°	-3°		0.67
	07	PSC50-SDUCL-18090-07X	50	32	25	18	90	68	101.5	0°	-3°		0.67

### 主要配件 | Main spare parts

接口尺寸 PSC size	刀片 Insert	刀垫螺钉 Shim screw	刀垫 Shim	扳手 Key	刀片螺钉 Insert screw
PSC32-PSC50	7	-	-	242.070.35	ILD2565

- 订货包含配件，不供应刀片产品
- 可单独订购配件，按需询价。

- The insert need to be ordered seperately. Other accessories are included in the order.
- The spare parts can be ordered separately. Please inquire on demand.



PSC毛坯 PSC Blank

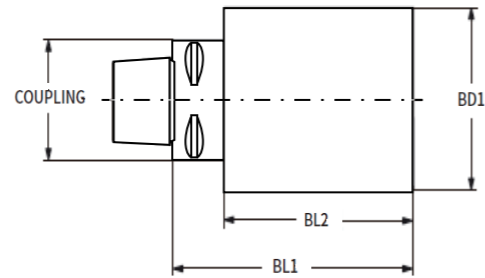

技术参数 | Technical parameters

单位 | Unit: mm

接口尺寸 PSC size	订货号 Ordering code	BD1	BL1	库存 Stock
PSC32	BLPSC32A040110M	40	110	▲
	BLPSC32A050110M	50	110	●
	BLPSC32A050125M	50	125	▲
	BLPSC32A070060M	70	60	▲
	BLPSC32A090070M	90	70	▲
PSC40	BLPSC40A040095M	40	95	▲
	BLPSC40A060130M	60	130	●
	BLPSC40A060165M	60	165	▲
	BLPSC40A080075M	80	75	▲
	BLPSC40A100085M	100	85	▲
PSC50	BLPSC50A050125M	50	125	●
	BLPSC50A075175M	75	175	●
	BLPSC50A090080M	90	80	▲
	BLPSC50A110090M	110	90	▲

转下页 see next page →

PSC毛坯 PSC Blank

技术参数 | Technical parameters

单位 | Unit: mm

接口尺寸 PSC size	订货号 Ordering code	BD1	BL1	库存 Stock
PSC63	BLPSC63A072120M	72	120	●
	BLPSC63A075195M	75	195	●
	BLPSC63A100080M	100	80	●
	BLPSC63A110085M	110	85	▲
	BLPSC63A130095M	130	95	●
PSC80	BLPSC80A080200M	80	200	▲
	BLPSC80A120095M	120	95	▲
	BLPSC80A120160M	120	160	●
	BLPSC80A130090M	130	90	●

供货期: ●可供现货 ▲交货时间短

Availability: ● available in stock ▲short lead time

PSC半成品毛坯前端带有42-46HRC硬度,允许加工成所需要的形状

PSC blank have a 42-46HRC hardness front, which allows machining of special shapes

### PSC接纳器

### PSC CLAMPING UNIT

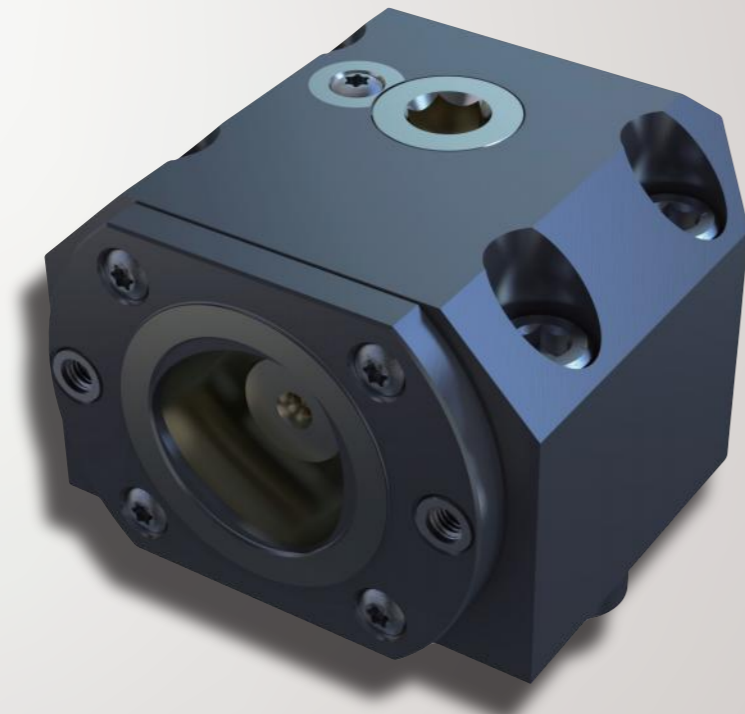

- 配合PSC接口的刀具使用;
- 可实现左右手刀具互换;
- 凸轮锁紧结构, 换刀便捷;

- Used with the turning tools with PSC interface;
- Realize the exchange of left and right hand tools;
- Cam locking device, change the tool swiftly.

## 命名方式 | Naming And Coding Rules

PSC	32
	40
	50
	63
	80

### 01.接口规格 | COUPLING TYPE

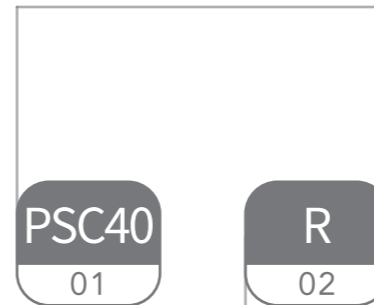

### 02.刀体方向 | HAND OF TOOL

L	左手方向   Left
R	右手方向   Right

CUSA	通用接纳器   General Purpose Receiver
CVDI	VDI接纳器   VDI Receiver
CSQUA	卧式刀塔接纳器   Horizontal Lathe Receiver

### 03.产品种类 | PRODUCT TYPE

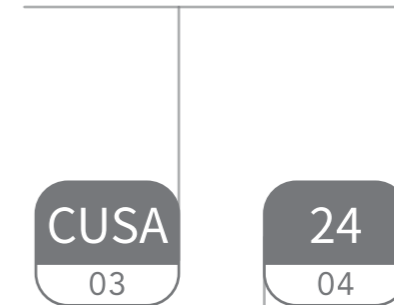

### 04.L<sub>1z</sub> | SIZE

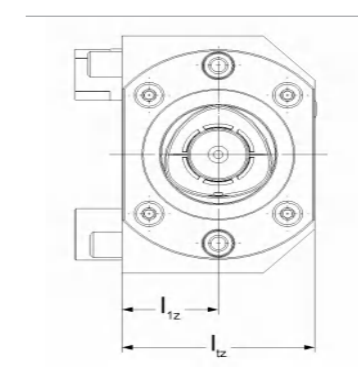

M	标准款   Standard
---	----------------

### 06.制式 | FORMAT

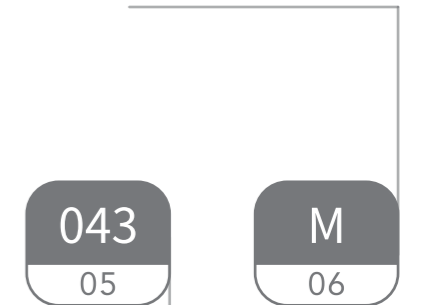

### 05.L<sub>1x</sub> | SIZE

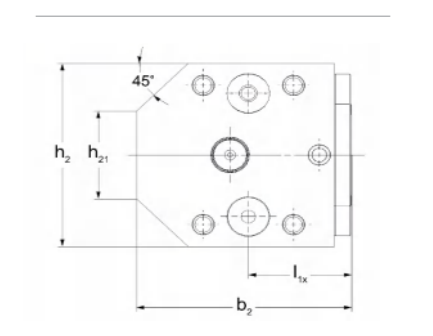

CUSA型

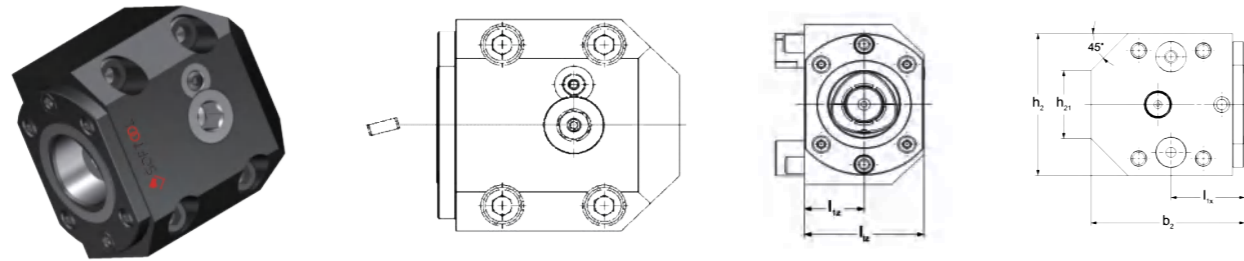

技术参数 | Technical parameters

单位 | Unit: mm

接口尺寸 PSC size	订货号 Ordering code	b2	h2	h21	l1x	l1z	l1t	重量 m (kg)
PSC32	PSC32RCUSA19039	73	54	30	39	19	38	1.3
PSC32	PSC32LCUSA19039	73	54	30	39	19	38	1.3
PSC40	PSC40RCUSA24043	86	77	38	43	24	48	2.26
PSC40	PSC40LCUSA24043	86	77	38	43	24	48	2.26
PSC50	PSC50RCUSA32048	100	92	44	48	32	64	3.74
PSC50	PSC50LCUSA32048	100	92	44	48	32	64	3.74
PSC63	PSC63RCUSA42060	122	105	37	60	42	84	7.1
PSC63	PSC63LCUSA42060	122	105	37	60	42	84	7.1
PSC80	PSC80RCUSA50088	146	133	133	88	50	100	13.25
PSC80	PSC80LCUSA50088	146	133	133	88	50	100	13.25

◎ 夹紧装置R\L RUSA应用设计说明  
Clamping device R \ L Rusa application design description

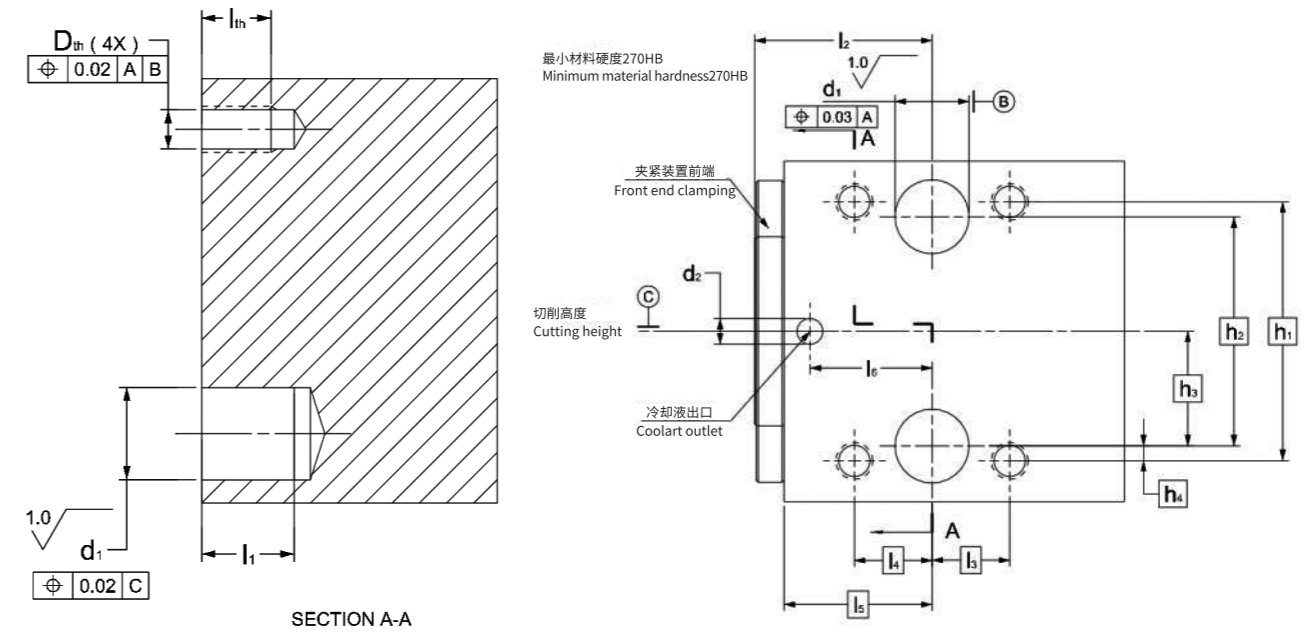

技术参数 | Technical parameters

单位 | Unit: mm

夹紧装置 Clamping Device	d1(H7)	d2	h1	h2	h3	h4	l1(min)	l2	l3	l4	l5	l6	lth(min)	Dth
PSC32R\LCUSA19039	12	5	42	39	19.5	1.5	8.5	39	19	19	33.5	28	7.5	M6
PSC40R\LCUSA24043	16	7	60	55	27.5	2.5	11	43	19	19	36.5	30	11	M8
PSC50R\LCUSA32048	20	7	70	62	31	4	12	48	21	21	39.5	33	13	M10
PSC63R\LCUSA42060	25	10	82	71	35.5	5.5	20	60	24.5	24.5	50.5	41	12	M10
PSC80R\LCUSA50088	32	11	110	92	46	9	20	88	43	43	76	63	14.5	M12

VDI外圆车刀接纳器 | VDI External Receiver

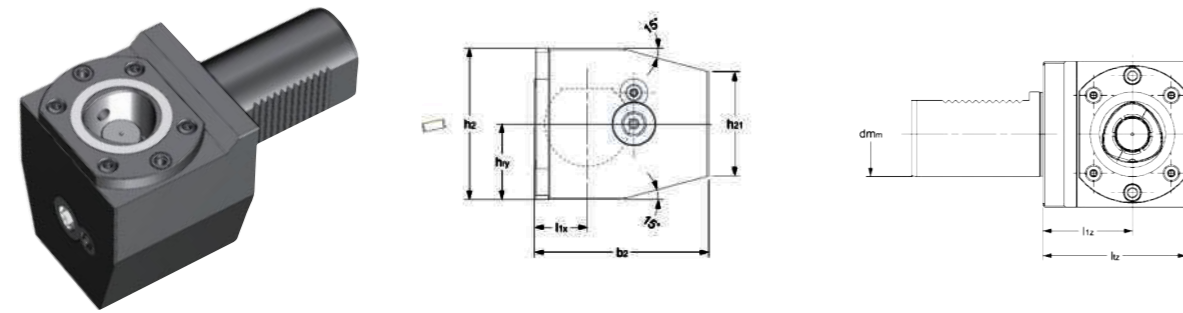

技术参数 | Technical parameters

单位 | Unit: mm

VDI尺寸 VDI size	接口尺寸 PSC size	订货号 Ordering code	b2	hry	h2	h21	l1x	l1z	ltz	重量 m (kg)
30	PSC32	PSC32-RCVDI30-41020M	74	30	57	38	20	41	60	2.1
30	PSC32	PSC32-LCVDI30-41020M	74	30	57	38	20	41	60	2.1
30	PSC32	PSC32-RCVDI30-41030M	73	30	57	41	30	41	60	2.2
30	PSC32	PSC32-LCVDI30-41030M	73	30	57	41	30	41	60	2.2
40	PSC40	PSC40-RCVDI40-51030M	86	38	75	54	30	51	75	3.2
40	PSC40	PSC40-LCVDI40-51030M	86	38	75	54	30	51	75	3.2
50	PSC40	PSC40-RCVDI50-51040M	86	38	75	60	40	51	75	3.2
50	PSC40	PSC40-LCVDI50-51040M	86	38	75	60	40	51	75	3.2
40	PSC50	PSC50-RCVDI40-53030M	99	41	82	47	30	53	85	5.7
40	PSC50	PSC50-LCVDI40-53030M	99	41	82	47	30	53	85	5.7
40	PSC50	PSC50-RCVDI40-53040M	99	41	82	53	40	53	85	5.7
40	PSC50	PSC50-LCVDI40-53040M	99	41	82	53	40	53	85	5.7
50	PSC50	PSC50-RCVDI50-41030M	86	43	86	66	30	41	65	5.7
50	PSC50	PSC50-LCVDI50-41030M	86	43	86	66	30	41	65	5.7
50	PSC50	PSC50-RCVDI50-53030M	99	43	86	59	30	53	85	5.7
50	PSC50	PSC50-LCVDI50-53030M	99	43	86	59	30	53	85	5.7
50	PSC50	PSC50-RCVDI50-53040M	99	43	86	65	40	53	85	5.7
50	PSC50	PSC50-LCVDI50-53040M	99	43	86	65	40	53	85	5.7
60	PSC50	PSC50-RCVDI60-43040M	99	53	94	76	40	43	75	5.7
60	PSC50	PSC50-LCVDI60-43040M	99	53	94	76	40	43	75	5.7
60	PSC63	PSC63-RCVDI60-53040M	122	53	105	70	40	53	95	6
60	PSC63	PSC63-LCVDI60-53040M	122	53	105	70	40	53	95	6

VDI内圆车刀接纳器 | VDI Internal Receiver

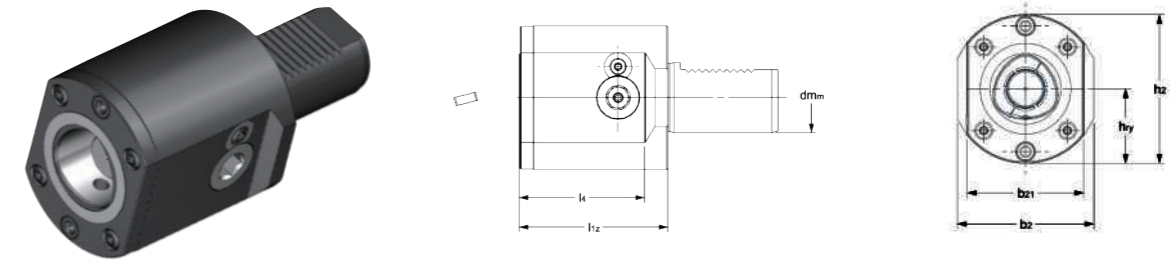

技术参数 | Technical parameters

单位 | Unit: mm

VDI尺寸 VDI size	接口尺寸 PSC size	订货号 Ordering code	b21	b2	hry	h2	l1z	l4	重量 m (kg)
30	PSC32	PSC32-RCVDI30-00060M	38	50	34	61	60	44	1
30	PSC32	PSC32-LCVDI30-00060M	38	50	34	61	60	44	1
40	PSC40	PSC40-RCVDI40-00075M	48	75	41	75	75	53	2.2
40	PSC40	PSC40-LCVDI40-00075M	48	75	41	75	75	53	2.2
50	PSC40	PSC40-RCVDI50-00065M	64	75	41	82	85	72	3.2
50	PSC40	PSC40-LCVDI50-00065M	64	75	41	82	85	72	3.2
40	PSC50	PSC50-RCVDI40-00085M	48	70	49	83	65	39	2.2
40	PSC50	PSC50-LCVDI40-00085M	48	70	49	83	65	39	2.2
50	PSC50	PSC50-RCVDI50-00085M	64	83	49	91	85	62	3.2
50	PSC50	PSC50-LCVDI50-00085M	64	83	49	91	85	62	3.2
60	PSC50	PSC50-RCVDI60-00075M	64	80	58	100	75	56	5.7
60	PSC50	PSC50-LCVDI60-00075M	64	80	58	100	75	56	5.7
60	PSC63	PSC63-RCVDI60-00095M	84	84	58	111	95	50	6.1
60	PSC63	PSC63-LCVDI60-00095M	84	84	58	111	95	50	6.1



卧式刀塔接纳器 | Horizontal Lathe Receiver

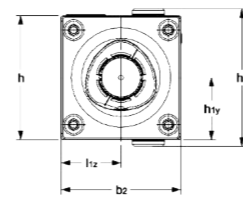
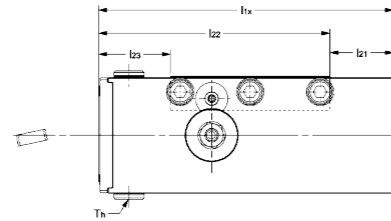

技术参数 | Technical parameters

单位 | Unit: mm

接口尺寸 PSC size	订货号 Ordering code	b2	h1y	h2	l1x	l1z	l21	l22	l23	Th	重量 m (kg)
PSC32	PSC32-RCSQUA-4038M	38	20	62	95	19	16.5	78.5	25	G1/8	1.3
PSC32	PSC32-LCSQUA-4038M	38	20	62	95	19	16.5	78.5	25	G1/8	1.3
PSC40	PSC40-RCSQUA-5048M	48	25	54	125	24	24	101	30.5	G1/8	2.3
PSC40	PSC40-LCSQUA-5048M	48	25	54	125	24	24	101	30.5	G1/8	2.3
PSC50	PSC50-RCSQUA-6464M	64	32	68	145	32	27	118	36	G1/8	3.2
PSC50	PSC50-LCSQUA-6464M	64	32	68	145	32	27	118	36	G1/8	3.2

方柄接杆

TOOL HOLDER ADAPTOR

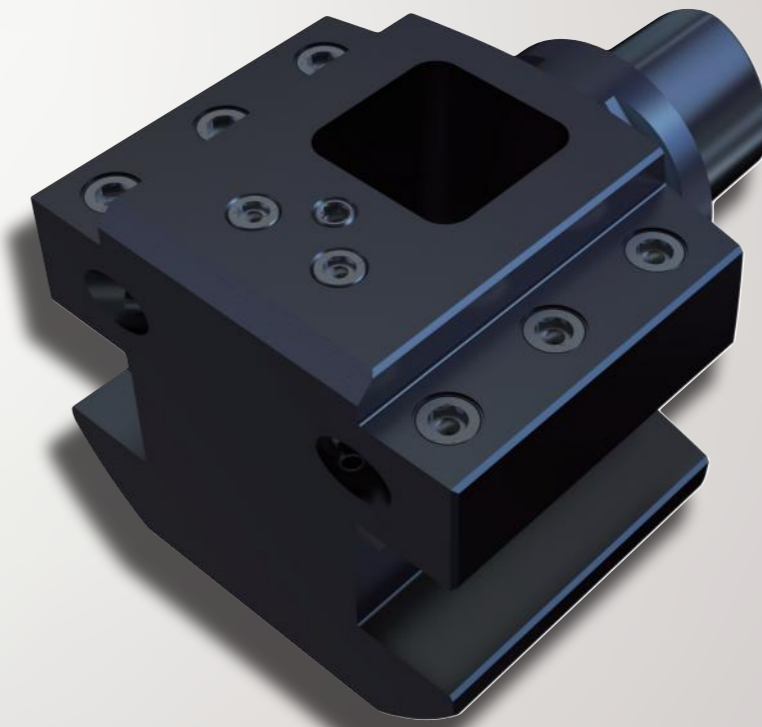

- 可用于传统方刀杆使用;
- 降低刀具使用成本;
- 无需机床内部(停机)对刀;
- 可以多角度应用。

- Can be used with traditional square tool holders;
- Reduce the tool cost;
- No need downtime to adjust the tool;
- Can be applied from multiple angles.

## 命名方式 | Naming And Coding Rules

PSC	32
	40
	50
	63
	80

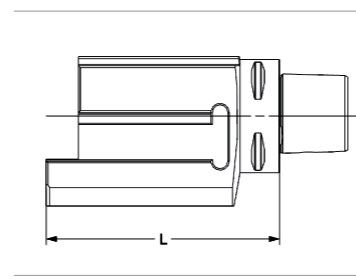

01.接口规格 | COUPLING TYPE

03.有效长度 | LENGTH



03.产品类型 | PRODUCT TYPE

ASHL	通用刀柄0°左手方向接杆   General Purpose 0° Left-Hand Adaptor
ASHR	通用刀柄0°右手方向接杆   General Purpose 0° Right-Hand Adaptor
ASHA	通用刀柄90°接杆   Purpose 90° Adaptor
ASHS	通用刀柄0°双向接杆   Purpose 0° Both-sides Adaptor

04.刀杆尺寸 | HEIGHT

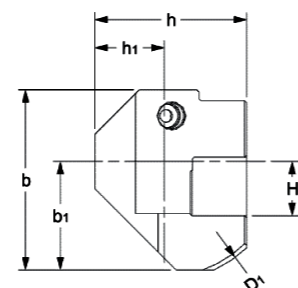

## 通用刀柄0°接杆 | General Purpose 0° Adaptor

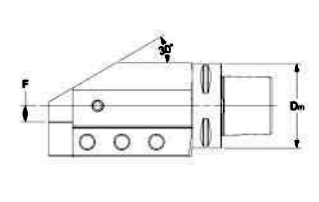
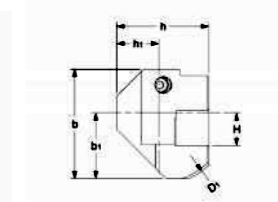
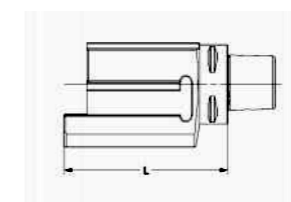

技术参数 | Technical parameters

单位 | Unit: mm

接口尺寸 PSC size	刀杆尺寸 Square size	订货号 Ordering code	Dm	L	F	H	b	h	D1	h1	b1	重量 m (kg)	螺钉 Screw
PSC50	20X20	PSC50-ASHR-095-20	50	95	10	20	55.5	69	85	37	30	1.69	251.080.20
PSC50	20X20	PSC50-ASHL-095-20	50	95	10	20	55.5	69	85	37	30	1.69	251.080.20
PSC63	20X20	PSC63-ASHR-105-20	63	105	10	20	63.5	69	85	37	30	2.39	251.080.20
PSC63	20X20	PSC63-ASHL-105-20	63	105	10	20	63.5	69	85	37	30	2.39	251.080.20
PSC63	25X25	PSC63-ASHR-122-25	63	122	13	25	70	78	100	46	38	3.17	251.100.18
PSC63	25X25	PSC63-ASHL-122-25	63	122	13	25	70	78	100	46	38	3.17	251.100.18
PSC80	25X25	PSC80-ASHR-122-25	80	122	15	25	80	86	103	46	40	4.06	251.100.20
PSC80	25X25	PSC80-ASHL-122-25	80	122	15	25	80	86	103	46	40	4.06	251.100.20
PSC80	32X32	PSC80-ASHR-140-32	80	140	8	32	80	95	110	55	40	5.13	251.120.30
PSC80	32X32	PSC80-ASHL-140-32	80	140	8	32	80	95	110	55	40	5.13	251.120.30

通用刀柄90°接杆 | General Purpose 90° Adaptor

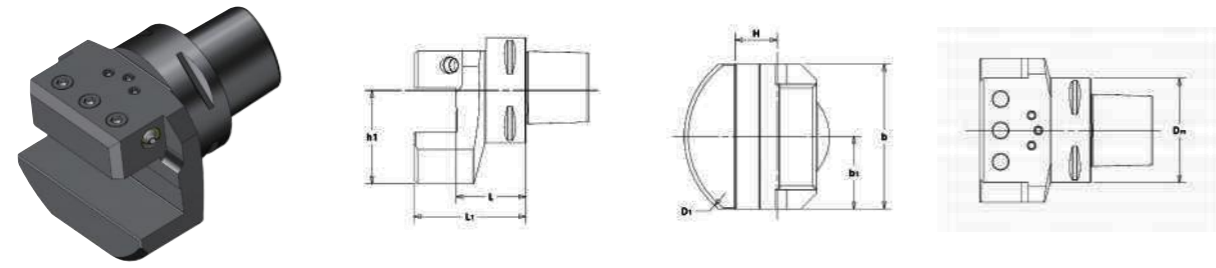

技术参数 | Technical parameters

单位 | Unit: mm

接口尺寸 PSC size	刀杆尺寸 Square size	订货号 Ordering code	Dm	L1	L	H	b	D1	h1	b1	重量 m (kg)	螺钉 Screw
PSC50	20X20	PSC50-ASHA-065-20	50	65	45	20	64	85	37	32	1.4	251.120.20
PSC63	20X20	PSC63-ASHA-070-20	63	70	50	20	64	85	37	32	1.8	251.120.20
PSC63	25X25	PSC63-ASHA-080-25	63	80	55	25	76	100	46	38	2.4	251.120.20
PSC80	25X25	PSC80-ASHA-075-25	80	75	50	25	80	103	46	38	3.1	251.120.20
PSC80	32X32	PSC80-ASHA-085-32	80	85	53	32	110	142	65	55	4.4	251.120.20

通用刀柄0°双向接杆 | General Purpose 0° Both-sides Adaptor

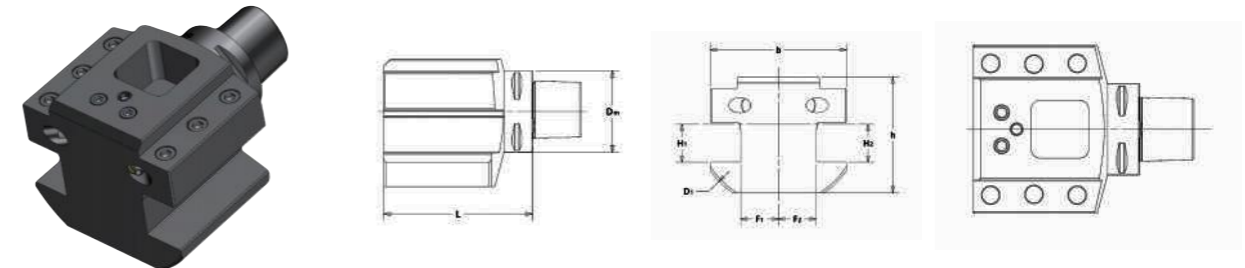

技术参数 | Technical parameters

单位 | Unit: mm

接口尺寸 PSC size	刀杆尺寸 Square size	订货号 Ordering code	Dm	L1	L2	F1	F2	H1	H2	b	h	D1	重量 m (kg)	螺钉 Screw
PSC63	25X25	PSC63-ASHS-122-25	63	122	122	20	20	25	25	90	78	114	4.5	251.120.20
PSC80	25X25	PSC80-ASHS-122-25	80	122	122	30	30	25	25	110	75	128	5.9	251.120.20

## 转接柄 ADAPTOR



- PSC接口具有更强的传动扭矩和稳定性;
- 刀柄模块化结构;
- 更易于维护和维修;
- 提高了使用寿命;
- 提供快换功能。

- Stronger transmission torque and stability with PSC interface;
- Modular structure of holder;
- More easy to maintain;
- Prolong the service life;
- Provide quick-change function.

## 命名方式 | Naming And Coding Rules

PSC	32	Arbor	A16A
	40		A22A
	50		A27A
	63		A32A
	80		A40A
			A40C
			A60C

02. 转换接口规格 | ADAPTER TYPE

M	标准款   Standard
A	短款   Short

04. 制式 | FORMAT

PSC40  
01

PSC40  
02

080  
03

M  
04

01. 主接口规格 | COUPLING TYPE

PSC	32	BT	30
	40		40
	50		50
	63		50
	80	HSK	63
			80
			100

03. 有效长度 | LENGTH

25	25mm	65	25mm	125	125mm
30	30mm	70	30mm	135	135mm
32	32mm	75	32mm	140	140mm
33	33mm	80	33mm	145	145mm
35	35mm	85	35mm	150	150mm
40	40mm	90	40mm	155	155mm
45	45mm	95	45mm	175	175mm
50	50mm	100	50mm	185	185mm
55	55mm	110	55mm	200	200mm
60	60mm	120	60mm		

PSC加长杆 | PSC Extension Adaptor

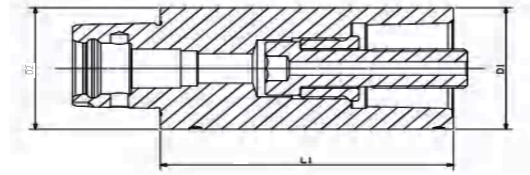

技术参数 | Technical parameters

单位 | Unit: mm

订货号 Ordering code	D1	D2	L1	重量 m (kg)
PSC32-PSC32-035A	32	32	35	0.22
PSC32-PSC32-060M	32	32	60	0.36
PSC32-PSC32-080M	32	32	80	0.47
PSC32-PSC32-095M	32	32	95	0.56
PSC40-PSC40-040A	40	40	40	0.4
PSC40-PSC40-060M	40	40	60	0.57
PSC40-PSC40-080M	40	40	80	0.7
PSC40-PSC40-120M	40	40	120	1.11
PSC50-PSC50-050A	50	50	50	0.73
PSC50-PSC50-080M	50	50	80	1.15
PSC50-PSC50-100M	50	50	100	1.38
PSC50-PSC50-150M	50	50	150	2.17
PSC63-PSC63-060A	63	63	60	1.36

转下页 see next page →

PSC加长杆 | PSC Extension Adaptor

技术参数 | Technical parameters

单位 | Unit: mm

订货号 Ordering code	D1	D2	L1	重量 m (kg)
PSC63-PSC63-100M	63	63	100	2.26
PSC63-PSC63-140M	63	63	140	3.17
PSC63-PSC63-185M	63	63	185	4.19
PSC80-PSC80-065A	80	80	65	2.41
PSC80-PSC80-100M	80	80	100	3.7
PSC80-PSC80-125M	80	80	125	4.64
PSC80-PSC80-200M	80	80	200	7.47

主要配件(M) | Main spare parts(M)

接口尺寸 PSC size	螺纹套 Threaded sleeve	拉钉 Pull stud	扳手 Key
PSC32	SRML1815155123	SCFM1215D16050	241.080.00
PSC40	SRML2215175143	SCFM1415D19057	241.080.00
PSC50	SRML2515200163	SCFM1615D22069	241.100.00
PSC63	SRML3015240203	SCFM2020D27087	241.140.00
PSC80	SRML3015240203	SCFM2020D27087	241.140.00

可单独订购配件，按需询价。

The spare parts can be ordered separately. Please inquire on demand.

主要配件(A) | Main spare parts(A)

接口尺寸 PSC size	拉钉 Pull stud	扣环 SOFTOOL	扳手 Key
PSC32-PSC32-035A	512.068.01	545.040.02	241.080.00
PSC40-PSC40-040A	512.068.02	545.040.03	241.080.00
PSC50-PSC50-050A	512.068.03	545.040.07	241.080.00
PSC63-PSC63-060A	512.068.04	545.040.08	241.140.00
PSC80-PSC80-065A	512.068.05	545.040.08	241.140.00



PSC缩颈杆 | PSC Reduction Adaptor

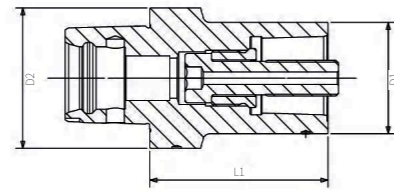

技术参数 | Technical parameters

单位 | Unit: mm

订货号 Ordering code	D1	D2	L1	重量 m (kg)
PSC40-PSC32-055M	32	40	55	0.49
PSC40-PSC32-070M	32	40	70	0.59
PSC40-PSC32-120M	32	40	120	0.81
PSC50-PSC32-033A	32	50	33	0.54
PSC50-PSC32-060M	32	50	60	0.68
PSC50-PSC32-120M	32	50	120	0.99
PSC50-PSC32-150M	32	50	150	1.65
PSC50-PSC40-040A	40	50	40	0.59
PSC50-PSC40-065M	40	50	65	0.8
PSC50-PSC40-085M	40	50	85	1.1
PSC50-PSC40-140M	40	50	140	1.46
PSC63-PSC32-032A	32	63	32	0.91
PSC63-PSC32-070M	32	63	70	1.12
PSC63-PSC32-125M	32	63	125	1.43
PSC63-PSC32-185M	32	63	185	2.99
PSC63-PSC40-040A	40	63	40	0.98
PSC63-PSC40-080M	40	63	80	1.32
PSC63-PSC40-145M	40	63	145	1.86
PSC63-PSC40-185M	40	63	185	3.23
PSC63-PSC50-050A	50	63	50	1.11

转下页 see next page →

PSC缩颈杆 | PSC Reduction Adaptor

技术参数 | Technical parameters

单位 | Unit: mm

订货号 Ordering code	D1	D2	L1	重量 m (kg)
PSC63-PSC50-080M	50	63	80	1.53
PSC63-PSC50-110M	50	63	110	2.23
PSC63-PSC50-175M	50	63	175	2.79
PSC80-PSC32-060M	32	80	60	2.07
PSC80-PSC32-135M	32	80	135	2.53
PSC80-PSC40-070M	40	80	70	2.2
PSC80-PSC40-155M	40	80	155	2.97
PSC80-PSC40-200M	40	80	200	5.42
PSC80-PSC50-045A	50	80	45	2
PSC80-PSC50-080M	50	80	80	2.43
PSC80-PSC50-185M	50	80	185	3.88
PSC80-PSC50-200M	50	80	200	5.84
PSC80-PSC63-055A	63	80	55	2.15
PSC80-PSC63-080M	63	80	80	2.65
PSC80-PSC63-120M	63	80	120	4.1
PSC80-PSC63-200M	63	80	200	5.37

主要配件(M) | Main spare parts(M)

接口尺寸 PSC size	螺纹套 Threaded sleeve	拉钉 Pull stud	扳手 Key
PSC32	SRML1815155123	SCFM1215D16050	241.080.00
PSC40	SRML2215175143	SCFM1415D19057	241.080.00
PSC50	SRLM2515200163	SCFM1615D22069	241.100.00
PSC63	SRLM3015240203	SCFM2020D27087	241.140.00
PSC80	SRLM3015240203	SCFM2020D27087	241.140.00

可单独订购配件，按需询价。

The spare parts can be ordered separately. Please inquire on demand.

主要配件(A) | Main spare parts(A)

接口尺寸 PSC size	拉钉 Pull stud	扣环 SOFTOOL	扳手 Key
PSC50-PSC32-033A	512.068.01	545.040.02	241.080.00
PSC50-PSC40-040A	512.068.06	545.040.07	241.080.00
PSC63-PSC32-032A	512.068.01	545.040.02	241.080.00
PSC63-PSC40-040A	512.068.02	545.040.03	241.080.00
PSC63-PSC50-050A	512.068.07	545.040.08	241.100.00
PSC80-PSC50-045A	512.068.08	545.040.08	241.100.00
PSC80-PSC63-055A	512.068.05	545.040.08	241.140.00

## PSC转芯轴接柄 | PSC with Type Arbor Adaptor

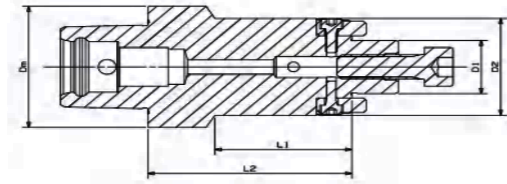

## 技术参数 | Technical parameters

单位 | Unit: mm

订货号 Ordering code	Dm	D1	D2	L1	L2	重量 m (kg)
PSC32-A16A-030M	32	16	32	15	30	0.25
PSC40-A16A-032M	40	16	32	10	32	0.38
PSC40-A16A-055M	40	16	32	33	55	0.4
PSC40-A22A-025M	40	22	40	-	25	0.4
PSC40-A22A-055M	40	22	40	25	55	0.6
PSC50-A16A-035M	50	16	32	10	35	0.6
PSC50-A16A-070M	50	16	32	45	70	0.7
PSC50-A22A-025M	50	22	50	-	25	0.62
PSC50-A22A-070M	50	22	40	47	70	0.9
PSC50-A27A-025M	50	27	50	-	25	0.68
PSC50-A32A-040M	50	32	63	20	40	1.14
PSC63-A16A-040M	63	16	32	10	40	1
PSC63-A22A-025M	63	22	50	-	25	0.96
PSC63-A22A-080M	63	22	40	40	80	1.4
PSC63-A27A-025M	63	27	50	-	25	1.01
PSC63-A27A-080M	63	27	50	55	80	1.6

转下页 see next page →

## PSC转芯轴接柄 | PSC with Type Arbor Adaptor

## 技术参数 | Technical parameters

单位 | Unit: mm

订货号 Ordering code	Dm	D1	D2	L1	L2	重量 m (kg)
PSC63-A32A-025M	63	32	63	-	25	1.09
PSC63-A40A-045M	63	40	70	20	45	1.75
PSC63-A40C-050M	63	40	88	28	50	2.4
PSC80-A16A-050M	80	16	32	10	50	2.1
PSC80-A22A-030M	80	22	80	-	30	1.86
PSC80-A22A-090M	80	22	40	45	90	2.4
PSC80-A27A-030M	80	27	50	-	30	1.91
PSC80-A27A-090M	80	27	50	50	90	2.7
PSC80-A32A-030M	80	32	80	-	30	2.02
PSC80-A40A-030M	80	40	80	-	30	2
PSC80-A40C-060M	80	40	88	30	60	3.47
PSC80-A60C-080M	80	60	130	50	80	7.78

## 主要配件 | Main spare parts

芯轴尺寸 Arbor size	键块(2X) Key block	键块螺钉(2X) Key block screw	安装螺钉 Screw	垫圈 Washer	扳手 Key block key	扳手 Key
A16A	141.011.04	113.030.06	120.080.25	-	241.025.56	241.060.90
A22A	141.011.01	113.040.10	120.100.35	-	241.030.63	241.080.00
A27A	141.010.01	113.040.12	120.120.35	133.120.30	241.030.63	241.100.00
A32A	141.010.04	-	120.160.40	133.160.30	241.040.70	241.140.00
A40A	141.010.02	113.060.15	120.200.45	133.200.40	241.050.80	241.170.00
A40C	142.010.02	113.060.20	113.120.40	-	241.050.80	241.100.00
A60C	141.011.02	113.120.25	113.160.50	-	241.100.00	241.140.00

可单独订购配件, 按需询价。

The spare parts can be ordered separately. Please inquire on demand.

## BT转PSC接柄 | BT with Type PSC Adaptor

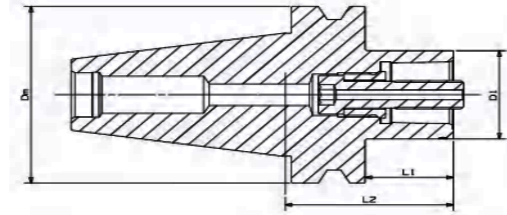

## 技术参数 | Technical parameters

单位 | Unit: mm

订货号 Ordering code	Dm	D1	L2	L1	重量 m (kg)
BT30-PSC32-030M	46	32	30	8	0.42
BT30-PSC32-060M	46	32	60	38	0.58
BT30-PSC40-060M	46	40	60	38	0.67
BT30-PSC50-080M	46	50	80	58	1.08
BT40-PSC32-030M	63	32	30	3	1
BT40-PSC32-060M	63	32	60	33	0.99
BT40-PSC40-030M	63	40	30	3	0.95
BT40-PSC40-060M	63	40	60	33	1.21
BT40-PSC50-030M	63	50	30	3	3.56
BT40-PSC50-070M	63	50	70	43	4.09
BT40-PSC63-075M	63	63	75	48	1.75
BT50-PSC32-040M	100	32	40	2	3.72
BT50-PSC32-070M	100	32	70	32	3.82
BT50-PSC40-040M	100	40	40	2	3.72
BT50-PSC40-070M	100	40	70	32	3.9
BT50-PSC50-040M	100	50	40	2	3.59

转下页 see next page →

## BT转PSC接柄 | BT with Type PSC Adaptor

## 技术参数 | Technical parameters

单位 | Unit: mm

订货号 Ordering code	Dm	D1	L2	L1	重量 m (kg)
BT50-PSC50-080M	100	50	80	42	4.13
BT50-PSC63-040M	100	63	40	2	3.61
BT50-PSC63-090M	100	63	90	52	4.71
BT50-PSC80-070M	100	80	70	32	4.16
BT50-PSC80-120M	100	80	120	82	6.02

## 主要配件 | Main spare parts

接口尺寸 PSC size	螺纹套 Threaded sleeve	拉钉 Pull stud	扳手 Key
			
PSC32	SRLM1815155123	SCFM1215D16050	241.080.00
PSC40	SRLM2215175143	SCFM1415D19057	241.080.00
PSC50	SRLM2515200163	SCFM1615D22069	241.100.00
PSC63	SRLM3015240203	SCFM2020D27087	241.140.00
PSC80	SRLM3015240203	SCFM2020D27087	241.140.00

可单独订购配件，按需询价。

The spare parts can be ordered separately. Please inquire on demand.

HSK转PSC接柄 | HSK with Type PSC Adaptor

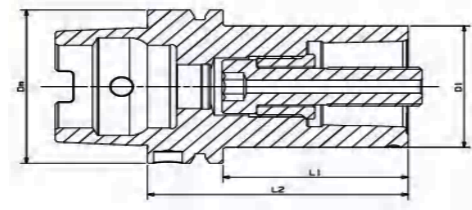

技术参数 | Technical parameters

单位 | Unit: mm

订货号 Ordering code	D1	L2	L1	Dm	重量 m (kg)
HSK50A-PSC32-075M	32	75	49	50	0.67
HSK50A-PSC40-080M	40	80	54	50	0.85
HSK63A-PSC32-075M	32	75	49	63	0.97
HSK63A-PSC40-080M	40	80	54	63	1.14
HSK63A-PSC50-090M	50	90	64	63	1.47
HSK80A-PSC40-090M	40	90	64	80	1.69
HSK80A-PSC50-095M	50	95	69	80	2.02
HSK80A-PSC63-110M	63	110	84	80	2.79
HSK100A-PSC32-080M	32	80	43	100	2.42
HSK100A-PSC40-090M	40	90	61	100	2.63
HSK100A-PSC50-100M	50	100	71	100	3.02
HSK100A-PSC63-110M	63	110	81	100	3.7
HSK100A-PSC80-120M	80	120	91	100	4.87

转下页 see next page →

HSK转PSC接柄 | HSK with Type PSC Adaptor

主要配件 | Main spare parts

接口尺寸 PSC size	螺纹套 Threaded sleeve	拉钉 Pull stud	扳手 Key
PSC32	SRLM1815155123	SCFM1215D16050	241.080.00
PSC40	SRLM2215175143	SCFM1415D19057	241.080.00
PSC50	SRLM2515200163	SCFM1615D22069	241.100.00
PSC63	SRLM3015240203	SCFM2020D27087	241.140.00
PSC80	SRLM3015240203	SCFM2020D27087	241.140.00

可单独订购配件，按需询价。

The spare parts can be ordered separately. Please inquire on demand.